

# User Manual

  
**AGRIMATE®**  
Maximum Power - Super Economy

## AM-400-PRO-4S BRUSH CUTTER



OPERATION AND MAINTENANCE MANUAL

**DISCLAIMER:** DUE TO CONSTANT UPGRADATION, FEATURES AND SPECIFICATIONS ARE SUBJECT TO CHANGE WITHOUT NOTICE



BEFORE OPERATING THIS MACHINE,  
PLEASE READ THESE INSTRUCTIONS CAREFULLY

## SAFETY FIRST

Instructions contained in warnings within this manual marked with a symbol concern critical points which must be taken into consideration to prevent possible serious bodily injury, and for this reason you are requested to read all such instructions carefully and follow them without fail.

## WARNINGS IN THE MANUAL

### WARNING

This mark indicates instructions, which must be followed in order to prevent accidents, which could lead to serious bodily injury or death.

### IMPORTANT

This mark indicates instructions, which must be followed, or it leads to mechanical failure, breakdown, or damage.

### NOTE

This mark indicates hints or directions useful in the use of the product.

## CONTENTS

1. Parts Identification
2. Specifications
3. Warning labels on the machine
4. Symbols on the machine
5. For safe operation
6. Set up
7. Fuel
8. Operation
9. Maintenance
10. Storage
11. Troubleshooting guide

## PARTS LOCATION

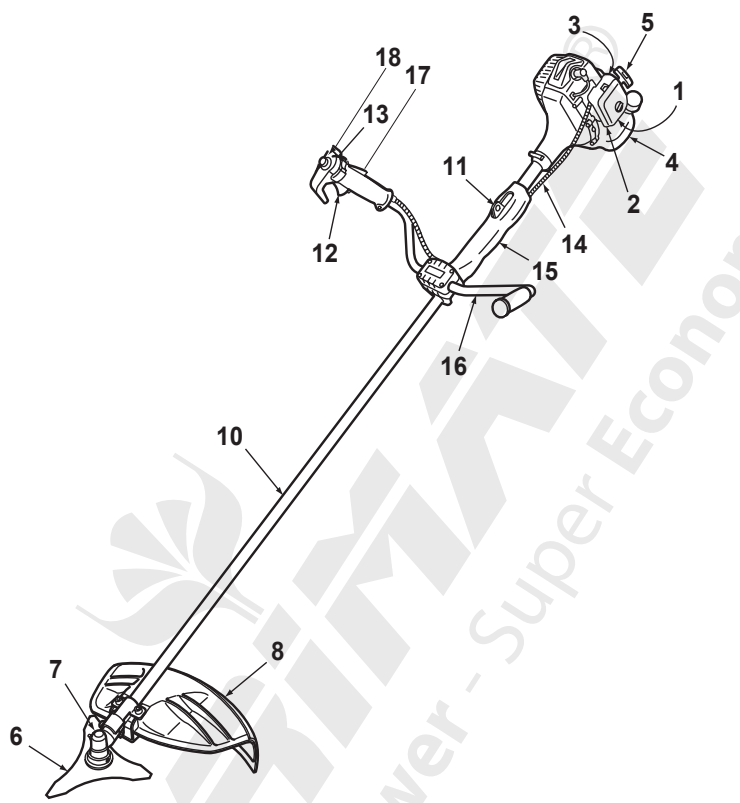

- |   |                   |    |                       |    |                      |
|---|-------------------|----|-----------------------|----|----------------------|
| 1 | Primer pump       | 7  | Gear case             | 13 | Ignition switch      |
| 2 | Air cleaner cover | 8  | Debris guard          | 14 | Throttle cable       |
| 3 | Choke lever       | 9  | Loop handle           | 15 | Protector (Optional) |
| 4 | Fuel tank         | 10 | Drive shaft housing   | 16 | Handle               |
| 5 | Starter knob      | 11 | Shoulder strap hanger | 17 | Throttle interlock   |
| 6 | Blade             | 12 | Throttle lever        | 18 | Half-throttle lock   |

## SPECIFICATION

Model	AM 400-PRO-4S
Engine	AM 39
Engine type	4-stroke, nickel plated cylinder, 1 cylinder
Displacement	38.8cm <sup>3</sup>
Bore × Stroke	40 × 30.9 mm
Max. output	1.1 KW /8000pm
Max. torque	1.9Nm/ 5,500 rpm
Max. rotation with no load	10,000 rpm
Fuel consumption	360 g/kwh(265g/PSH)
Cooling system	Forced air
Ignition system	Transistor magneto
PTO shaft rotation	Counter clockwise
Oil Capacity	80 ML
Fuel tank Capacity	600 ML

Note:

Specifications may be vary according to the types, and are subject to change without notice.

## WARNING LABELS ON THE MACHINE



Read owner's manual before operating this machine.



Warning / Attention



Wear head, eye and ear protection.

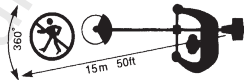

Keep all children, bystanders and helpers 15 meters away from the machine.



If warning label peels off or becomes soiled and impossible to read, you should contact the dealer from which you purchased the product to order new labels and affix them in the required location(s).



Never modify your machine. We won't warrant the machine, if you use there modeled brush Cutter or if you don't observe the proper usage written in the manual.

## SYMBOLS ON THE MACHINE

For safe operation and maintenance, symbols are carved in relief on the machine. According to these indications, please be careful not to make a mistake.



The port to refuel the "MIX GASOLINE"  
**Position:** FUEL TANK CAP



The direction to close the choke  
**Position:** AIR CLEANER COVER



The direction to open the choke  
**Position:** AIR CLEANER COVER

## ▲ FOR SAFE OPERATION



1. Read this manual carefully until you completely understand and follow all safety and operating instructions.
2. Keep this manual handy so that you may refer to it later whenever any questions arise. Also note, if you have any questions which cannot be answered herein, contact the dealer from whom you purchased the product.



3. Always be sure to include this manual when selling, lending, or otherwise transferring the ownership of this product.
4. Never allow children or anyone unable to fully understand the directions given in the manual to use the machine.

## WORKING CONDITION



1. When using the product, you should wear proper clothing and protective equipment.
  - (1) Helmet
  - (2) Ear protectors
  - (3) Protection goggles or face protector
  - (4) Thick work gloves
  - (5) Non-slip-sole work boots
2. And you should carry with you.
  - (1) Attached tools
  - (2) Properly reserved fuel
  - (3) Spare blade
  - (4) Things to notify your working area (rope, warning signs)
  - (5) Whistle (for collaboration or emergency)
  - (6) Hatchet or saw (for removal of obstacles)



3. Do not wear loose clothing, jewelry, short trousers, sandals, or go barefoot. Do not wear anything which might be caught by a moving part of the unit. Secure hair so it is above shoulder length.

## WORKING CIRCUMSTANCE



1. Never start the engine inside a closed room or building. Exhaust gases contain dangerous carbon monoxide.

2. Never use the product,

- a. when the ground is slippery or when you can't maintain a steady posture.

- b. At night, at times of heavy fog, or at any other times when your field of vision might be limited and it would be difficult to gain a clear view of the working area.

- c. During rain storms, during lightning storms, at times of strong or gale-force winds, or at any other times when weather conditions might make it unsafe to use the product.



## WORKING PLAN



1. You should never use the product when under the influence of alcohol, when suffering from exhaustion or lack of sleep, when suffering from drowsiness as a result of having taken cold medicine or at any other time when a possibility exists that your judgment might be impaired or that you might not be able to operate the product properly and in a safe manner.



2. When planning your work schedule, allow plenty of time to rest. Limit the amount of time over which the product is to be used continuously to somewhere around 30 ~ 40 minutes per

session, and take 10 ~ 20 minutes of rest between work sessions. Also try to keep the total amount of work performed in a single day under 2 hours or less.

## WARNING



1. If you don't observe the working time, or working manner (**See "USING THE PRODUCT"**), Repetitive Stress Injury (RSI) could occur.

If you feel discomfort, redness and swelling of your fingers or any other part of your body, see a doctor before getting worse.

2. To avoid noise complaints, in general, operate product between 8 a.m. and 5 p.m. on weekdays and 9 a.m. to 5 p.m. on weekends.

## NOTE

Check and follow the local regulations as to sound level and hours of operations for the product.

## BEFORE STARTING THE ENGINE



1. The area within a perimeter of 15 m (50 ft) of the person using the product should be considered a hazardous area into which no one should enter. If necessary, yellow warning rope, warning signs should be placed around the perimeter of the area. When work is to be performed simultaneously by two or more persons, care should also be taken to constantly look around or otherwise check for the presence and locations of other people working so as to maintain a distance between each person sufficient to ensure safety.
2. Check the condition of working area to avoid any accident by hitting hidden obstacles such as stumps, stones, cans, or broken glass.

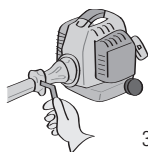

## ! IMPORTANT

Remove any obstacle before beginning work.

3. Inspect the entire unit for loose fasteners and fuel leakage. Make sure that the cutting attachment is properly installed and securely fastened.



4. Be sure the debris guard is firmly attached in place.
5. Always use the shoulder strap. Adjust the strap for comfort before starting the engine. The strap should be adjusted so the left hand can comfortably hold the handlebar grip approximately waist high.

## STARTING THE ENGINE

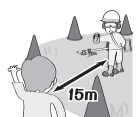

1. Keep bystanders and animals at least 15 m (50 ft) away from the operating point. If you are approached, immediately stop the engine.

2. The product is equipped with a centrifugal clutch mechanism, so the cutting attachment begins to rotate as soon as the engine is started by putting the throttle into the start position. When starting the engine, place the product onto the ground in a flat clear area and hold it firmly in place so as to ensure that neither the cutting part nor the throttle come into contact with any obstacle when the engine starts.



## ! WARNING

**Never place the throttle into the high-speed position when starting the engine.**

3. After starting the engine, check to make sure that the cutting attachment stops rotating when the throttle is moved fully back to its original position. If it continues to rotate even after the throttle has been moved fully back, turn off the engine and take the unit to your dealer for repair.



## USING THE PRODUCT

## ! IMPORTANT

Cut only materials recommended by the manufacturer. And use only for tasks explained in the manual.



1. Grip the handles firmly with both hands using your whole hand. Place your feet slightly apart (slightly further apart than the width of your shoulders) so that your weight is distributed evenly across both legs, and always be sure to maintain a steady, even posture while working.



2. Keep cutting attachment below waist level.
3. Maintain the speed of the engine at the level required to perform cutting work, and never raise the speed of the engine above the level necessary.

4. If the unit starts to shake or vibrate, turn off the engine and check the whole unit. Do not use it until the trouble has been properly corrected.



5. Keep all parts of your body away from rotating cutting attachment and hot surfaces.



6. Never touch the muffler, spark plug, or other metallic parts of the engine while the engine is in operation or immediately after shutting down the engine. Doing so could result in serious burns or electrical shock.

## IF SOMEONE COMES

1. Guard against hazardous situations at all times. Warn adults to keep pets and children away from the area. Be careful if you are approached. Injury may result from flying debris.
2. If someone calls out or otherwise interrupts you while working, always be sure to turn off the engine before turning around.

## MAINTENANCE



1. In order to maintain your product in proper working order, perform the maintenance and checking operations described in the manual at regular intervals.
2. Always be sure to turn off the engine before performing any maintenance or checking procedures.

### WARNING

**The metallic parts reach high temperatures immediately after stopping the engine.**

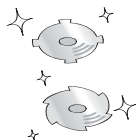

3. When replacing the cutting attachment or any other part, or when replacing the oil or any lubricant, always be sure to **use only qualified products**.
4. In the event that any part must be replaced or any maintenance or repair work not described in this manual must be performed, please contact your dealer for assistance.
5. Do not use any accessory or attachment other than those recommended for the unit.
6. Under no circumstances should you ever take apart the product or alter it in any way. Doing so might result in the product becoming damaged during operation or the product becoming unable to operate properly.

## HANDLING FUEL



1. The engine of the product is designed to run on a mixed fuel, which contains highly flammable gasoline. Never store cans of fuel or refill the tank of the unit in any place where there is a boiler, stove, wood fire, electrical sparks, welding sparks, or any other source of heat or fire which might ignite the fuel.
2. Never smoke while operating the unit or refilling its fuel tank.
3. When refilling the tank, always turn off the engine and allow it to cool down. Take a careful look around to make sure that there are no sparks or open flames anywhere nearby before refueling.
4. Wipe spilled fuel completely using a dry rag if any fuel spillage occurs during refueling.
5. After refueling, screw the fuel cap back tightly onto the fuel tank and then carry the unit to a spot 3 more away from where it was refueled before turning on the engine.

## TRANSPORTATION



1. When hand-carrying the product, cover over the cutting part if necessary, lift up the product and carry it paying attention to the blade.
2. Never transport the product over rough roads over long distances by vehicle without removing all fuel from the fuel tank. If doing so, fuel might leak from the tank during transport.



## SET UP

### INSTALLING HANDLE (BCG1E34F)

- Mount the handle to the shaft tube and clamp it at a location that is comfortable to you.

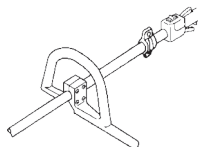

### INSTALLING HANDLE (BCG1E40F-5)

- Loosen the 4 bolts on the upper cap and insert the handles equally. Retighten the bolts.
- Put the handle assembly into the bracket and put the upper cap over it. Tighten the cap securely.

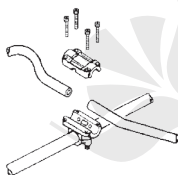

### INSTALLING DEBRIS GUARD FOR LINE HEAD

- Attach the debris guard with the bolts provided while inserting the spacer between the guard and the pipe.

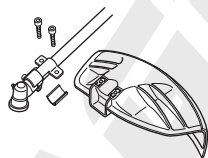

### MOUNTING THE 3 OR 4 TEETH BLADE

**Always switch off the engine and disconnect the spark plug cap before mounting metal cutter blades!**

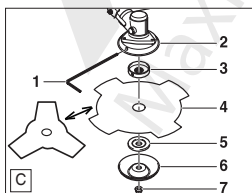

- Remove the cotter pin.
- Unscrew the locknut (C/7) from the shaft by turning it clockwise. If necessary, block the angle gear (see below).

### NOTE

The locknut is provided with a left-hand thread!

- Remove oating disc (C/6) and thrust washer (C/5).
- Insert the o set screwdriver 4 mm (C/1) through the winding guard and the locking disc into the opening (C/3) in the angular gear (block the winding gear). If necessary turn the mounting disc (C/3) slightly.

Position the blade (C/4), thrust washer (C/5) and finally the floating disc (C/6) as shown.

- Screw down the locknut (C/7) and tighten it by turning the combination wrench counter-clockwise.

**Caution:** For safety reasons, after every 10 tool changes the locknut (C/7) must be replaced with a new one.

- Put back the cotter pin.
- Remove Allen key and check for freedom of motion of the cutting tool.

### INSTALLING THE TRIMMER HEAD

Always switch off the engine and nect the spark plug cap mounting the trimmer head!

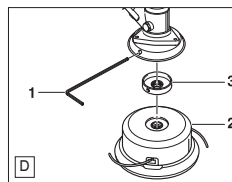

- Place the mounting disc (D/3) on the shaft.
- Insert the 4 mm Allen key (D/1) through the winding guard and the mounting disc (D/3) into the opening on the angle gear (blocks the angle gear). If necessary turn the mounting disc (D/3) slightly.
- Screw the trimmer head (D/2) onto the shaft by turning it counter-clockwise.
- Now tighten the trimmer head by hand.
- Remove the Allen key and check for freedom of motion of the trimmer head.

## INSTALLING DEBRIS GUARD FOR METAL BLADE

- When using metal blade, make sure to remove the guard skirt.

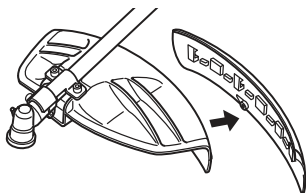

## BALANCE UNIT

- Put on strap and attach unit to strap.
- Slide clamp up or down until unit balances with head aparting from the ground when using it.



## FUEL

### ⚠ WARNING

- Gasoline is very flammable. Avoid smoking or bringing any flame or sparks near fuel. Make sure to stop the engine and allow it cool before refueling the unit. Select outdoor bare ground for fueling and move at least 3 m (10 ft) away from the fueling point before starting the engine.**



- The engines are lubricated by oil specially formulated for air-cooled 2-cycle gasoline engine use.  
Use an anti-oxidant added quality oil expressly labeled for air-cooled 2-cycle engine use (JASO FC GRADE OIL or ISO EGC GRADE).
- Do not use BIA or TCW (2-stroke water-cooling type) mixed oil.



### RECOMMENDED MIXING RATIO GASOLINE 25:OIL 1

Exhaust emission are controlled by the fundamental engine parameters and components (eq., carburetion, ignition timing and port timing) without addition of any major hardware or the introduction of an inert material during combustion.

- These engines are certified to operate on unleaded gasoline.
- Make sure to use gasoline with a minimum octane number of 89RON (USA/Canada: 87AL).
- If you use a gasoline of a lower octane value than prescribed, there is a danger that the engine temperature may rise and an engine problem such as piston seizing may consequently occur.
- Unleaded gasoline is recommended to reduce the contamination of the air for the sake of your health and the environment.
- Poor quality gasoline's or oils may damage sealing rings, fuel lines or fuel tank of the engine.

### HOW TO MIX FUEL

#### ⚠ WARNING

Pay attention to agitation.

- Measure out the quantities of gasoline and oil to be mixed.
- Put some of the gasoline into a clean, approved fuel container.
- Pour in all of the oil and agitate well.
- Pour in the rest of gasoline and agitate again for at least one minute. As some oils may be difficult to agitate depending on oil ingredients, sufficient agitation is necessary for the engine to last long. Be careful that, if the agitation is insufficient, there is an increased danger of early piston seizing due to abnormally lean mixture.
- Put a clear indication on the outside of the container to avoid mixing up with gasoline or other containers.
- Indicate the contents on outside of container for easy identification.

## FUELING THE UNIT

1. Untwist and remove the fuel cap. Rest the cap on a dustless place.
2. Put fuel into the fuel tank to 80% of the full capacity.
3. Fasten the fuel cap securely and wipe up any fuel spillage around the unit.

### WARNING

1. Select bare ground for fueling.
2. Move at least 10 feet (3 meters) away from the fueling point before starting the engine.
3. Stop the engine before refueling the unit. At that time, be sure to sufficiently agitate the mixed gasoline in the container.

## FOR YOUR ENGINE LIFE, AVOID

1. FUEL WITH NO OIL (RAW GASOLINE) – It will cause severe damage to the internal engine parts very quickly.
2. GASOHOL – It can cause deterioration of rubber and/or plastic parts and disruption of engine lubrication.

3. OIL FOR 4-CYCLE ENGINE USE – It can cause spark plug fouling, exhaust port blocking, or piston ring sticking.
4. **Mixed fuels which have been left unused for a period of one month or more may clog the carburetor and result in the engine failing to operate properly.**
5. In the case of storing the product for a long period of time, clean the fuel tank after rendering it empty. Next, activate the engine and empty the carburetor of the composite fuel.
6. In the case of scrapping the used mixed oil container, scrap it only at an authorized repository site.

### NOTE

- As for details of quality assurance, read the description in the section Limited Warranty carefully. Moreover, normal wear and change in product with no functional influence are not covered by the warranty. Also, be careful that, if the usage in the instruction manual is not observed as to the mixed gasoline, etc. described therein, it may not be covered by the warranty.

## OPERATION

### STARTING ENGINE

#### WARNING

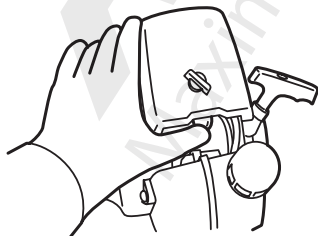

**The cutting head will start rotating upon the engine starts.**

1. Feed fuel into the fuel tank and tighten the cap securely.
2. Rest the unit on a flat, firm place. Keep the cuttinghead off the ground and clear of surrounding objects, as it will start rotating upon starting of the engine.
3. Push the primer pump several times until overflowfuel flows out in the clear tube.

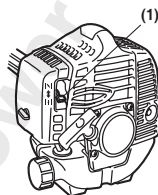

4. Move the choke lever to the closed position.



-  (2) (1) choke lever  
 (2) close  
 (3) (3) open

5. Set the ignition switch to the "I" position. Set the throttle lever to the half-throttle position (1 2 3). Place the unit on a flat, firm place. Keep the cutting head clear of everything around it.

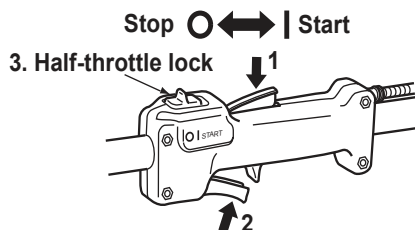

- While holding the unit firmly, pull out the starter rope quickly until engine fires.



### ⚠ WARNING

The product is equipped with a centrifugal clutch mechanism, so the cutting attachment begins to rotate as soon as the engine is started by putting the throttle into the start position. When starting the engine, place the product onto the ground in a flat clear area and hold it firmly in place so as to ensure that neither the cutting part nor the throttle come into contact with any obstacle when the engine starts.

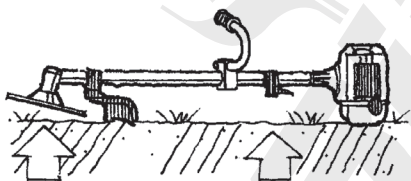

### ! IMPORTANT

- Avoid pulling the rope to its end or returning it by releasing the knob. Such actions can cause starter failures.
- Move the choke lever downward to open the choke. And restart engine.
  - Allow the engine to warm up for a several minutes before starting operation.

### 📖 NOTE

- When restarting the engine immediately after stopping it, leave the choke open.
- Over choking can make the engine hard to start due to excess fuel. When the engine failed to start after several attempts, open the choke and repeat pulling the rope, or remove the spark plug and dry it.

## STOPPING ENGINE

Stop ○ ↔ | Start  
Ignition switch

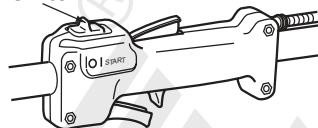

- Release the throttle lever and run the engine for half a minute.
- Shift the ignition switch to the STOP position.

### ! IMPORTANT

- Except for an emergency, avoid stopping the engine while pulling the throttle lever.

## ADJUSTING THROTTLE CABLE

- The normal play is 1 or 2 mm when measured at the carburetor side end. Readjust with the cable adjuster as required.

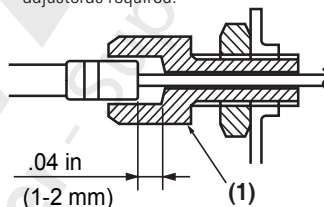

(1) Cable adjuster

## ADJUSTING IDLING SPEED

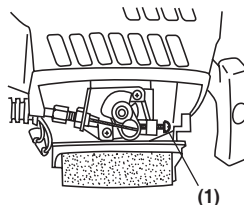

(1) Idle adjusting screw

- When the engine tends to stop frequently at idling mode, turn the adjusting screw clockwise.
- When the cutting head keeps rotating after releasing the trigger, turn the adjusting screw counter-clockwise.

## NOTE

- Warm up the engine before adjusting the idling speed.

## CUTTER APPLICATION CHART

- Replace by a suitable recommended cutting attachment according to the object to be cut.
- When replacing blade always be sure to use products which have been recommended by your dealer.

## WARNING

- When sharpening, removing, or reattaching the blade, be sure to wear thick, sturdy gloves and use only proper tools and equipment to prevent injury.



## METAL BLADE USAGE

1. Check the nut to fasten the blade and be sure the nut has no fault, and no abrasion.
2. Be sure that the blade and the holder have been fastened according to instruction and the blade turns smoothly without abnormal noise.



## WARNING

- The rotating parts fastened incorrectly may Cause serious accident to the operator.

- Make sure that the blade is not bent, warped, cracked, broken or damaged.
- If you find any error to the blade, discard it and change new one which is recommended by your dealer.
- By using the shoulder strap, hang the unit on your right side. Adjust the strap length so that the cutting head may become parallel to the ground.

## WARNING

- Make sure to use shoulder strap and debris guard. If not, it is very dangerous when you slip or lose your balance.



## CUTTING METHOD

- (a) Use the front left side cutting.
- (b) Guide the blade from your right to left with it tilted slightly to your left.
- (c) When mowing a wide area, start working from your left end to avoid interference of cut grass.
- (d) The blade may be seized by weeds if the engine speed is too low, or the blade cuts too deep into weeds. Adjust the engine speed and cutting depth according to the condition of object.

## WARNING

- If the grass or other object gets caught in the blade, or if the unit starts to shake or vibrate, turn off the engine and check the whole unit. Change the blade if it has been damaged.
- Turn off the engine and make sure the blade has completely stop before checking the blade, and removing any object got caught in.

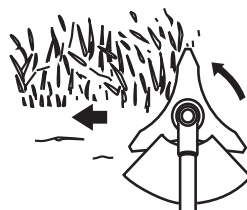

## CONTROLLING BLADE BOUNCE

- Kick out can cause serious personal injury. Carefully study this section. It is important that you understand what causes kick out, how you can reduce the chance of kick out and how you can remain in control of the unit if kick out does occur.

### 1. What causes kick out :

- Kick out can occur when the moving blade contacts an object that it cannot cut. This contact causes the blade to stop for an instant and then suddenly move or "bounce" away from the object that was hit. The operator can lose control of the unit and the blade can cause serious personal injury to the operator or any person nearby if the blade contacts any part of the body.

### 2. How you can reduce the chance of kick out :

- a. Recognize that kick out can happen. By understanding and knowing about bounce, you can help eliminate the element of surprise.
- b. Cut fibrous weeds and grass only. Do not let the blade contact materials it cannot cut such as hard, woody vines and brush or rocks, fences, metal, etc
- c. Be extra prepared for bounce if you must cut where you cannot see the blade making contact such as in areas of dense growth.
- d. Keep the blade sharp. A dull blade increase the chance of bounce.
- e. Avoid feeding the blade too rapidly. The blade can bounce away from material being cut if the blade is fed faster than its cutting capability.
- f. Cut only from your right to your left.
- g. Keep your path of advance clear of material that has been cut and other debris.

### 3. How you can maintain the best control:

- a. Keep a good, firm grip on the unit with both hands. A firm grip can help neutralize bounce. Keep your right and left hands completely around the respective handles.
- b. Keep both feet spread apart in a comfortable stance and yet braced for the possibility that the unit could bounce. Do not overreach. Keep firm footing and balance.

## CUTTING WORK (LINE HEAD USAGE)

### ▲ WARNING

1. **Always wear eye protection such as safety goggles. Never lean over the rotating cutting head. Rocks or other debris could be thrown into eyes and face and cause serious personal injury.**

2. **Keep the debris guard in place at all times when the unit is operated. Remember to remove the cover from the line cutter (knife) which locates on the debris guard. You can adjust the line to the right length at any time by lightly tapping the trimmer head against the ground. The line cutter cuts off the excessive line automatically.**

## TRIMMING GRASS AND WEEDS

- Always remember that the TIP of the line does cutting. You will achieve better results by not crowding the line into the cutting area. Allow the unit to trim at its own pace.
1. Hold the unit so the head is off the ground and is tilted about 20 degrees toward the sweep direction.



2. You can avoid thrown debris by sweeping from your left to the right.
3. Use a slow, deliberate action to cut heavy growth. The rate of cutting motion will depend on the material being cut. Heavy growth will require slower action than will light growth.
4. Never swing the unit so hard as you are in danger of losing your balance or control of the unit.
5. Try to control the cutting motion with the hip rather than placing the full workload on the arm and hands.
6. Take precautions to avoid wire, grass and dead, dry, long-stem weeds from wrapping around the head shaft. Such materials can stall the head and cause the clutch to slip, resulting in damage to the clutch system if repeated frequently.

## ADJUSTING THE LINE LENGTH

- Your brush cutter is equipped with a semi-auto type nylon line head that allows the operator to advance the line without stopping the engine. When the line becomes short, lightly tap the head on the ground while running the engine at full throttle.
- Each time the head is bumped, the line advances about 25 mm. For better effect, tap the head on bear ground or hard soil. Avoid bumping in thick, tall grass as the engine may stall by overload.





7. Line up the slot on the bottom cap with the hook on the housing, press the cap against the housing until it clicks.

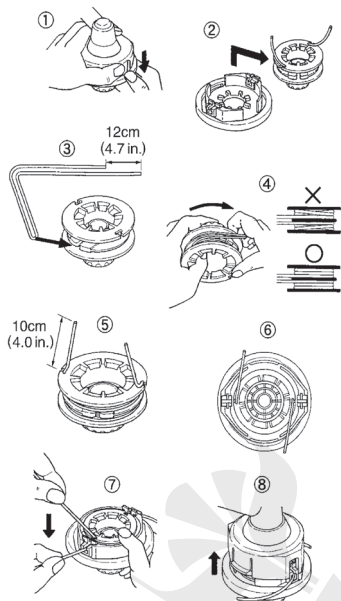

### ⚠ WARNING

- Make sure that the engine has stopped and is cool before performing any service to the machine. Contact with moving cutting head or hot muffler may result in a personal injury.

### AIR FILTER

- The air filter, if clogged, will reduce the engine performance. Check and clean the filter element in warm, soapy water as required. Dry completely before installing. If the element is broken or shrunk, replace with a new one.

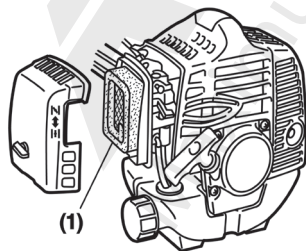

(1) Air filter

### FUEL FILTER

- When the engine runs short of fuel supply, check the fuel cap and the fuel filter for blockage.

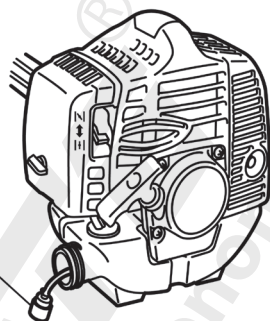

(1) Fuel filter

### SPARK PLUG

- Starting failure and misfiring are often caused by a fouled spark plug. Clean the spark plug and check that the plug gap is in the correct range. For a replacement plug, use the correct type specified by YOUR DEALER.

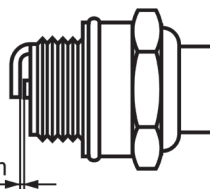

0.6-0.7 mm

### ! IMPORTANT

- Note that using any spark plug other than those designated may result in the engine failing to operate properly or in the engine becoming overheated and damaged.
- To install the spark plug, first turn the plug until it is finger tight, then tighten it a quarter turn more with a socket wrench.

87-104 in-lbs

TIGHTENING TORQUE: (9.8-11.8 N.m.)

MUFFLER



## ⚠ WARNING

- Inspect periodically, the muffler for loose fasteners, any damage or corrosion. If any sign of exhaust leakage is found, stop using the machine and have it repaired immediately.
- Note that failing to do so may result in the engine catching on fire.**

## SPARK ARRESTER

- The muffler is equipped with a spark arrester to prevent red hot carbon from flying out of the exhaust outlet. Periodically inspect and clean as necessary with a wire brush.

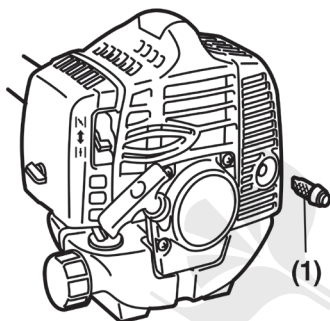

(1) Spark arrester

## GEAR CASE

- The reduction gears are lubricated by multipurpose, lithium-based grease in the gear case. Supply new grease every 25 hours of use or more often depending on the job condition.
- Remove the bolt opposite to the grease nipple before installing new grease to arrange for old grease to exit.

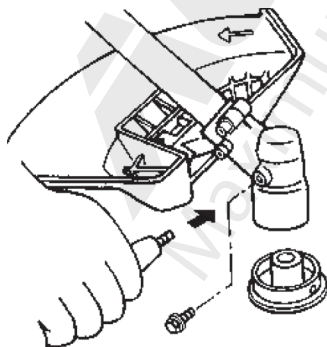

## INTAKE AIR COOLING VENT

### ⚠ WARNING

- Never touch the cylinder, muffler, or spark plugs with your bare hands immediately after stopping the engine. The engine can become very hot when in operation, and doing so could result in severe burns.**
- When checking the machine to make sure that it is okay before using it, check the area around the muffler and remove any wood chips or leaves which have attached themselves to the brushcutter. Failing to do so could cause the muffler to become overheated and that in turn could cause the engine to catch on fire. Always make sure that the muffler is clean and free of wood chips, leaves, and other waste before use.**
- Check the intake air cooling vent and the area around the cylinder cooling fins after every 25 hours of use for blockage, and remove any waste which has attached itself to the brushcutter. Note that it is necessary to remove the engine cover shown in order to be able to view the upper part of the cylinder.**

### ! IMPORTANT

- If waste gets stuck and causes blockage around the intake air cooling vent or between the cylinder fins, it may cause the engine to overheat, and that in turn may cause mechanical failure on the part of the brushcutter.

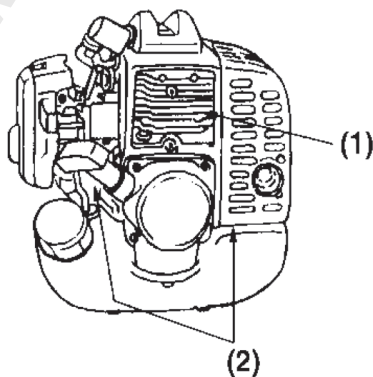

(1) Cylinder

(2) Intake air cooling vent

## PROCEDURES TO BE PERFORMED AFTER EVERY 100 HOURS OF USE

1. Remove the muffler, insert a screwdriver into the vent, and wipe away any carbon buildup. Wipe away any carbon buildup on the muffler exhaust vent and cylinder exhaust port at the same time
2. Tighten all screws, bolts, and fittings.
3. Check to see if any oil or grease has worked its way in between the clutch lining and drum, and if it has, wipe it away using oil-free, lead-free gasoline.



## STORAGE

Aged fuel is one of major causes of engine starting failure. Before storing the unit, empty the fuel tank and run the engine until it uses all the fuel left in the fuel line and the carburetor. Store the unit indoor taking necessary measures for rust prevention

## TROUBLESHOOTING GUIDE

### Case 1. Starting failure

CHECK	PROBABLE CAUSES	ACTION
fuel tank	incorrect fuel	drain it and use correct fuel
fuel filter	fuel filter is clogged	clean
carburetor adjustment screw	out of normal range	adjust to normal range
sparkling (no spark)	spark plug is fouled/wet plug gap is incorrect	clean/dry correct (GAP: 0.6-0.7 mm)
spark plug	disconnected	retighten

### Case 2. Engine starts but does not keep running/hard re-starting

CHECK	PROBABLE CAUSES	ACTION
fuel tank	incorrect fuel or staled fuel	drain it and use correct fuel
carburetor adjustment screw	out of normal range	adjust to normal range
muffler, cylinder (exhaust port)	carbon is built-up	wipe away
air cleaner	clogged with dust	wash
cylinder fin, fan cover	clogged with dust	clean

When your unit seems to need further service, please consult with our service shop in your area.

# ENGINE DIAGRAM OF AM-400-PRO-4S BRUSH CUTTER

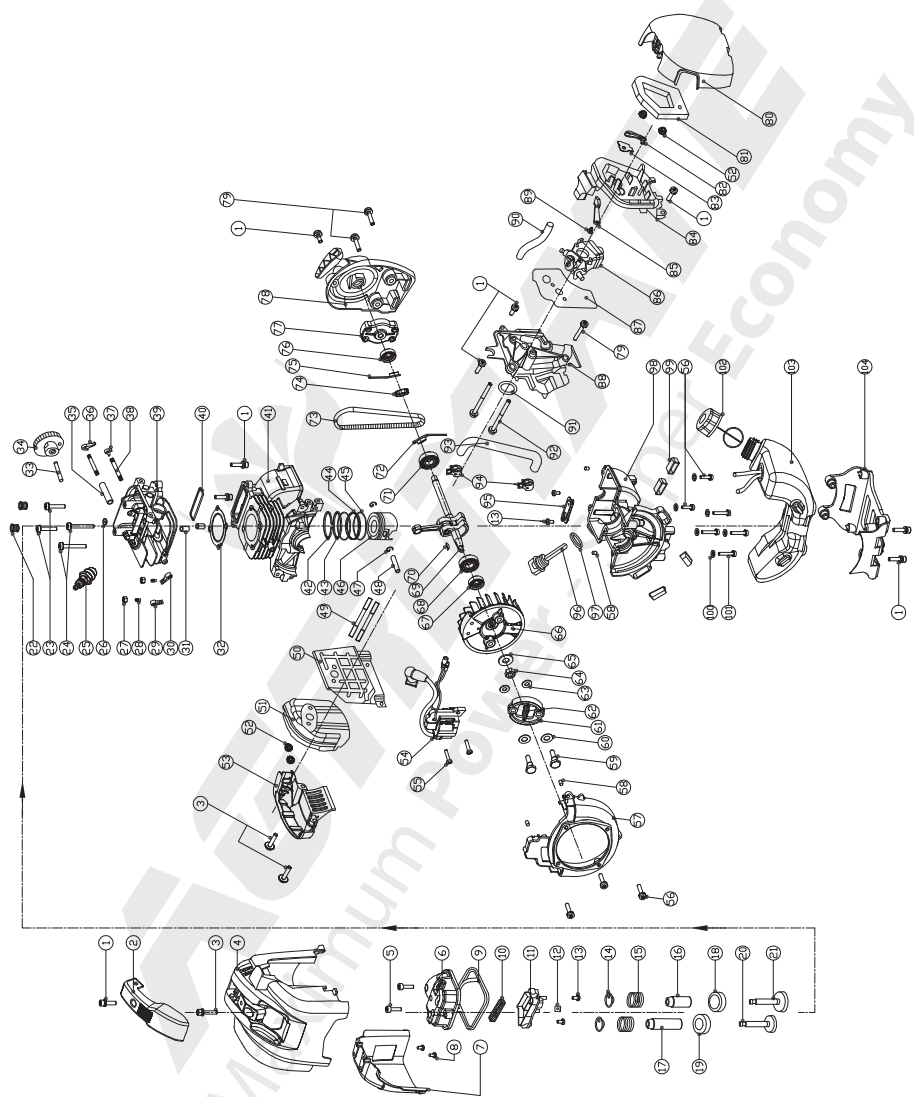

# ENGINE PART NO. OF AM-400-PRO-4S BRUSH CUTTER

PART NO.	NAME
AM-400-PRO-4S-E-01	M5×L16
AM-400-PRO-4S-E-02	Spark Plug Cover
AM-400-PRO-4S-E-03	M5×L20
AM-400-PRO-4S-E-04	Cylinder Cover
AM-400-PRO-4S-E-05	M5×14 Screw
AM-400-PRO-4S-E-06	Cylinder Head Cover
AM-400-PRO-4S-E-07	Muffler Adiabatic Cover
AM-400-PRO-4S-E-08	St2.9×8 Tapping Screw
AM-400-PRO-4S-E-09	Cylinder Head Cover Seal
AM-400-PRO-4S-E-10	Iron Filter
AM-400-PRO-4S-E-11	Fuel Return Plate
AM-400-PRO-4S-E-12	Oil Gas Separator
AM-400-PRO-4S-E-13	M4×L10
AM-400-PRO-4S-E-14	Retainer Valve Spring
AM-400-PRO-4S-E-15	Valve Spring
AM-400-PRO-4S-E-16	
AM-400-PRO-4S-E-17	
AM-400-PRO-4S-E-18	
AM-400-PRO-4S-E-19	
AM-400-PRO-4S-E-20	Inlet Valve
AM-400-PRO-4S-E-21	Exhaust Valve
AM-400-PRO-4S-E-22	
AM-400-PRO-4S-E-23	M5×L30
AM-400-PRO-4S-E-24	M5×L40
AM-400-PRO-4S-E-25	Spark Plug
AM-400-PRO-4S-E-26	
AM-400-PRO-4S-E-27	M5×P0.5 Adjust Nut

PART NO.	NAME
AM-400-PRO-4S-E-28	M5×P0.5 Adjust Blot
AM-400-PRO-4S-E-29	Exhaust Rocker Arm
AM-400-PRO-4S-E-30	Inlet Rocker Arm
AM-400-PRO-4S-E-31	Locating Sleeve
AM-400-PRO-4S-E-32	Cylinder Cover Gasket
AM-400-PRO-4S-E-33	Camshaft
AM-400-PRO-4S-E-34	Cam
AM-400-PRO-4S-E-35	
AM-400-PRO-4S-E-36	Exhaust Valve Lifter
AM-400-PRO-4S-E-37	Inlet Valve Lifter
AM-400-PRO-4S-E-38	Rocker Arm Shaft
AM-400-PRO-4S-E-39	Cylinder Cover
AM-400-PRO-4S-E-40	Cylinder Cover Ring
AM-400-PRO-4S-E-41	Cylinder Body 1
AM-400-PRO-4S-E-42	First Piston Ring
AM-400-PRO-4S-E-43	Secend Piston Ring
AM-400-PRO-4S-E-44	
AM-400-PRO-4S-E-45	
AM-400-PRO-4S-E-46	Piston
AM-400-PRO-4S-E-47	Piston Snap Ring
AM-400-PRO-4S-E-48	Piston Pin
AM-400-PRO-4S-E-49	M5×55 Double Threaded Screw
AM-400-PRO-4S-E-50	Muffler Baffler
AM-400-PRO-4S-E-51	Muffler
AM-400-PRO-4S-E-52	M5 Hex Nut
AM-400-PRO-4S-E-53	Muffler Down Frame Cover
AM-400-PRO-4S-E-54	Ignition

PART NO.	NAME
AM-400-PRO-4S-E-80	Air Filter Cover
AM-400-PRO-4S-E-81	Filter Element
AM-400-PRO-4S-E-82	Air Clear Baffle
AM-400-PRO-4S-E-83	
AM-400-PRO-4S-E-84	Air Filter Inner Cover Assembly
AM-400-PRO-4S-E-85	Air Clear Lock
AM-400-PRO-4S-E-86	Carburetor
AM-400-PRO-4S-E-87	Carburetor Gasket
AM-400-PRO-4S-E-88	Carburetor Shroud
AM-400-PRO-4S-E-89	St2.9×L7
AM-400-PRO-4S-E-90	Balance Pipe
AM-400-PRO-4S-E-91	Inlet Pipe Ring
AM-400-PRO-4S-E-92	M5×55 Hex Bolt
AM-400-PRO-4S-E-93	Rubricating Oil Pipe
AM-400-PRO-4S-E-94	Pipe Clamp
AM-400-PRO-4S-E-95	Reed Hold Valve
AM-400-PRO-4S-E-96	Oil Rule
AM-400-PRO-4S-E-97	Oil Rule Washer
AM-400-PRO-4S-E-98	Crankcase
AM-400-PRO-4S-E-99	Damping Rubber
AM-400-PRO-4S-E-100	D10×D5.3×T1
AM-400-PRO-4S-E-101	M5×L35 Screw
AM-400-PRO-4S-E-102	Fuel Tank Lid
AM-400-PRO-4S-E-103	Fuel Tank Assembly
AM-400-PRO-4S-E-104	Fuel Tank Support Frame

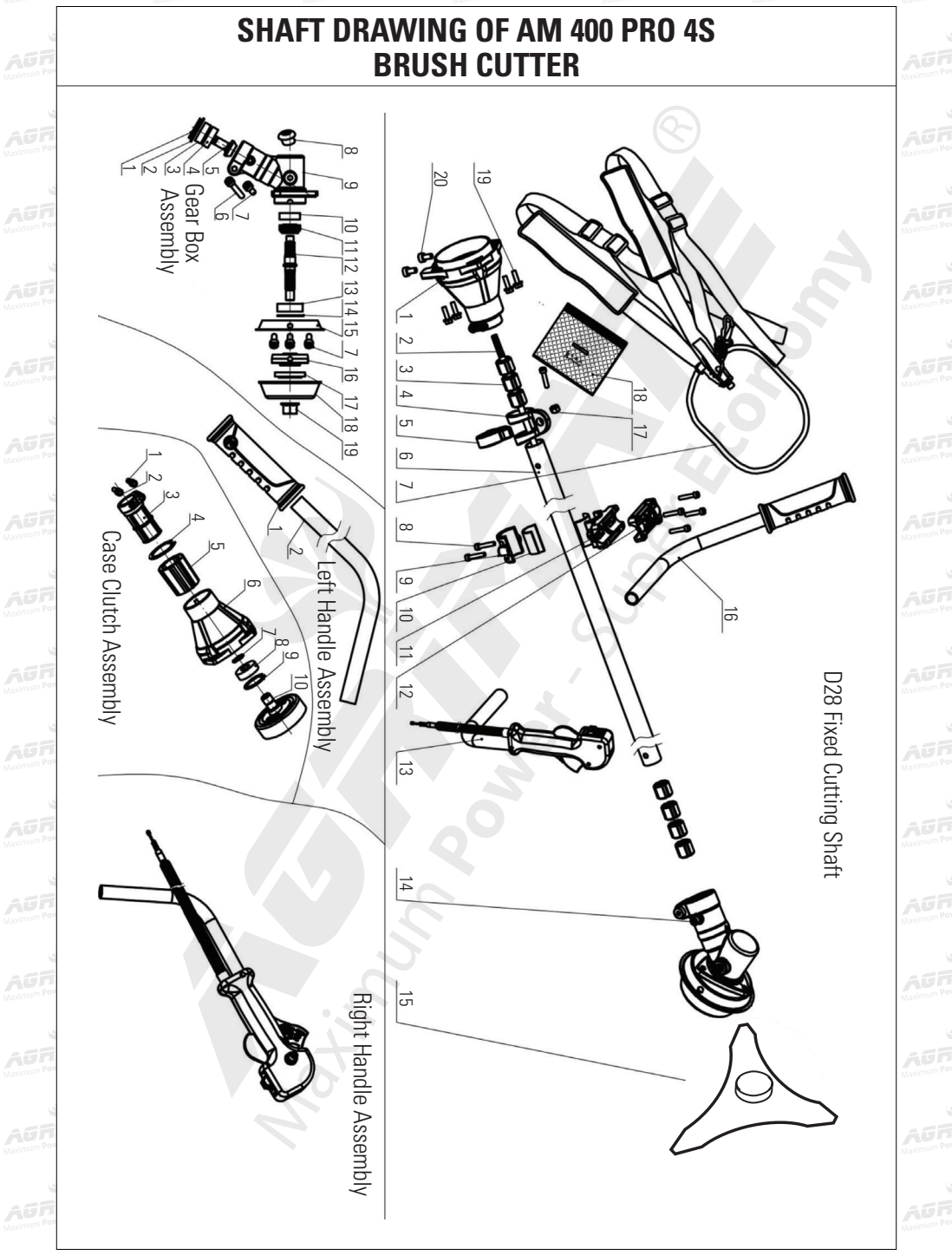



# SHAFT & PART NO. OF AM 400 PRO 4S BRUSH CUTTER

PART NO.	NAME
AM 400 PRO 4S-T-01	Case clutch assembly
AM 400 PRO 4S-T-02	Drive shaft
AM 400 PRO 4S-T-03	Ogalloy ass'yD34
AM 400 PRO 4S-T-04	Belt hanger
AM 400 PRO 4S-T-05	Clamp kit
AM 400 PRO 4S-T-06	Tube
AM 400 PRO 4S-T-07	Shoulder belt
AM 400 PRO 4S-T-08	Socket head bolt (M5xP0.8x25)
AM 400 PRO 4S-T-09	Lower cover
AM 400 PRO 4S-T-10	Rubber spacer
AM 400 PRO 4S-T-11	Handle cover
AM 400 PRO 4S-T-12	Upper cover
AM 400 PRO 4S-T-13	Right handle ass'y
AM 400 PRO 4S-T-14	Gear box
AM 400 PRO 4S-T-15	Cutting balde
AM 400 PRO 4S-T-16	Left handle ass'y
AM 400 PRO 4S-T-17	Nut M5
AM 400 PRO 4S-T-18	Cashion supporter
AM 400 PRO 4S-T-19	Hexagon boltt with flange (M6xP1.0x20)
AM 400 PRO 4S-T-20	Socket head bolt (M6xP1.0x12)
	<b>CASE CLUTCH</b>
AM 400 PRO 4S-T-C 1	Hexagon bolt with flange (M6xP1.0x30)
AM 400 PRO 4S-T-C 2	Hexagon bolt with flange (M5xP0.8x10)
AM 400 PRO 4S-T-C 3	Tube
AM 400 PRO 4S-T-C 4	Washer
AM 400 PRO 4S-T-C 5	Damper
AM 400 PRO 4S-T-C 6	Case clutch

PART NO.	NAME
AM 400 PRO 4S-T-C 7	Washer
AM 400 PRO 4S-T-C 8	Bearing
AM 400 PRO 4S-T-C 9	Washer
AM 400 PRO 4S-T-C 10	Clutch drum
	<b>LEFT HANDLE ASSEMBLY</b>
AM 400 PRO 4S-T-H 1	Left handle bar
AM 400 PRO 4S-T-H 2	Left handle
	<b>GEAR BOX ASSEMBLY</b>
AM 400 PRO 4S-T-G 1	Washer $\phi 10$
AM 400 PRO 4S-T-G 2	Washer $\phi 26$
AM 400 PRO 4S-T-G 3	Bearing 6000 LB C3
AM 400 PRO 4S-T-G 4	Bearing 6000 C3
AM 400 PRO 4S-T-G 5	Conical
AM 400 PRO 4S-T-G 6	Hexagon nut with flange (M6xP1.0x30)
AM 400 PRO 4S-T-G 7	Hexagon nut with flange (M5xP0.8x12)
AM 400 PRO 4S-T-G 8	Hexagon nut with flange (M10xP1.5x12)
AM 400 PRO 4S-T-G 9	Gear box
AM 400 PRO 4S-T-G 10	Bearing 629 C3
AM 400 PRO 4S-T-G 11	Conical
AM 400 PRO 4S-T-G 12	Castellated shaft
AM 400 PRO 4S-T-G 13	Bearing 6201 LLB C3
AM 400 PRO 4S-T-G 14	Washer $\phi 32$
AM 400 PRO 4S-T-G 15	Guard
AM 400 PRO 4S-T-G 16	Receive washer
AM 400 PRO 4S-T-G 17	Clamp washer
AM 400 PRO 4S-T-G 18	Cup
AM 400 PRO 4S-T-G 19	Collar nut M10

## INSPECTION & MAINTENANCE

For safety use, make sure the machine is cleaned every three-months. Before working, make sure to inspect the filter and the nozzle, and ensure there is no impurity. After working, make sure there is no water in the pump and the hose.

If the machine needs to be repaired in the guarantee period, please return the machine to the shop. You need to provide the certificate of purchase in order to repair or get the substitute.

Before Packing, the machine should be cleaned, then use closed packaging, packaging should be firm. Store the machine in dry place.

For transportation safety. The machine should comply with ISTA.



Meaning of crossed - out wheeled dustbin:

Do not dispose of electrical machines as unsorted municipal waste, use separate collection facilities.

If electrical machines are disposed of in landfills or dumps, hazardous substances can leak into the groundwater and get into the food chain, damaging your health and well-being.

When replacing old machines with new ones, the retailer is legally obligated to take back your old machine for disposals at least free of charge.



## Warranty Card

### CUSTOMER COPY



Date \_\_\_\_\_

Purchaser's Name & Address

\_\_\_\_\_  
\_\_\_\_\_  
\_\_\_\_\_

Product Name

**AM-400-PRO-4S BRUSH CUTTER**

Product Serial No.

\_\_\_\_\_

Invoice / DN No.

\_\_\_\_\_

Date of Delivery

\_\_\_\_\_

Dealer's Office Seal

\_\_\_\_\_

Dealer Sign \_\_\_\_\_

Customer Sign. \_\_\_\_\_

I/We accept the terms and conditions of Warranty as in the Warranty Card.

## Warranty Card

### DEALER'S COPY



Date \_\_\_\_\_

Purchaser's Name & Address

\_\_\_\_\_  
\_\_\_\_\_  
\_\_\_\_\_

Product Name

**AM-400-PRO-4S BRUSH CUTTER**

Product Serial No.

\_\_\_\_\_

Invoice / DN No.

\_\_\_\_\_

Date of Delivery

\_\_\_\_\_

Dealer's Office Seal

\_\_\_\_\_

Dealer Sign \_\_\_\_\_

Customer Sign. \_\_\_\_\_

I/We accept the terms and conditions of Warranty as in the Warranty Card.

## Warranty Card

### COMPANY COPY



Date \_\_\_\_\_

Purchaser's Name & Address

\_\_\_\_\_  
\_\_\_\_\_  
\_\_\_\_\_

Product Name

**AM-400-PRO-4S BRUSH CUTTER**

Product Serial No.

\_\_\_\_\_

Invoice / DN No.

\_\_\_\_\_

Date of Delivery

\_\_\_\_\_

Dealer's Office Seal

\_\_\_\_\_

Dealer Sign \_\_\_\_\_

Customer Sign. \_\_\_\_\_

I/We accept the terms and conditions of Warranty as in the Warranty Card.

1. **LIMITED WARRANTY PERIOD** : For a period of six months from the date of Sale / delivery of the product which ever is earlier. 2. **LIMITED WARRANTY OBLIGATION** : Replacement of defective part(s) by authorized dealer are free of charges. If found defective by reasons of defective material / poor workmanship, parts will be replaced and there will be no value re-imbursement. 3. **TERMS & CONDITIONS** : a. Claims under warranty will be accepted on submission of Warranty Card duly filled and stamped by authorized dealer together with the original purchase document. : b. Shipping / transportation / Incidental charges incurred in replacing defective parts under warranty shall be borne by the purchaser.

**WARRANTY null & void if**

- (i) Lack of maintenance, (ii) Incorrect use of the machine or tampering, (iii) Use of non-genuine spare parts, (iv) Usage of acids, solvents, or any flammable materials, (v) Non-usage of filter water / clear water / soft water & using water above 40°C temperature, (vi) While using the pressure washers to draw water which is contaminated with dust & solvents (eg. paint thinners, gasoline, oil, etc.), (vii) Repair done by unauthorized service people, (viii) Those parts subject to wear & tear due to normal operations and plastic parts, rubber items etc, (ix) Loose connections, faulty electrical fixtures & fluctuations in power supply.
4. Should any failure occur during or after the warranty period, customer does not have the right to interrupt payment / price discount.
5. Incidental or consequential damages like inconvenience commercial loss, loss of tie, mental agony etc.
6. Loss of any nature due to operation or non-operation is not covered under warranty.
7. All free service are at Dealer's service point only.
8. Warranty ceases if service is not done periodically.
9. The attached card should be completed and returned to Ratnagiri Impex Pvt. Ltd. for registration immediately after sale / delivery.
10. The warranty is void unless you register the warranty card with Ratnagiri Impex Pvt. Ltd.
11. The decision of Ratnagiri Impex Pvt. Ltd., in settling the warranty is final in all respects.
12. All disputes are subject to Bangalore Courts Jurisdiction

1. **LIMITED WARRANTY PERIOD** : For a period of six months from the date of Sale / delivery of the product which ever is earlier. 2. **LIMITED WARRANTY OBLIGATION** : Replacement of defective part(s) by authorized dealer are free of charges. If found defective by reasons of defective material / poor workmanship, parts will be replaced and there will be no value re-imbursement. 3. **TERMS & CONDITIONS** : a. Claims under warranty will be accepted on submission of Warranty Card duly filled and stamped by authorized dealer together with the original purchase document. : b. Shipping / transportation / Incidental charges incurred in replacing defective parts under warranty shall be borne by the purchaser.

**WARRANTY null & void if**

- (i) Lack of maintenance, (ii) Incorrect use of the machine or tampering, (iii) Use of non-genuine spare parts, (iv) Usage of acids, solvents, or any flammable materials, (v) Non-usage of filter water / clear water / soft water & using water above 40°C temperature, (vi) While using the pressure washers to draw water which is contaminated with dust & solvents (eg. paint thinners, gasoline, oil, etc.), (vii) Repair done by unauthorized service people, (viii) Those parts subject to wear & tear due to normal operations and plastic parts, rubber items etc, (ix) Loose connections, faulty electrical fixtures & fluctuations in power supply.
4. Should any failure occur during or after the warranty period, customer does not have the right to interrupt payment / price discount.
5. Incidental or consequential damages like inconvenience commercial loss, loss of tie, mental agony etc.
6. Loss of any nature due to operation or non-operation is not covered under warranty.
7. All free service are at Dealer's service point only.
8. Warranty ceases if service is not done periodically.
9. The attached card should be completed and returned to Ratnagiri Impex Pvt. Ltd. for registration immediately after sale / delivery.
10. The warranty is void unless you register the warranty card with Ratnagiri Impex Pvt. Ltd.
11. The decision of Ratnagiri Impex Pvt. Ltd., in settling the warranty is final in all respects.
12. All disputes are subject to Bangalore Courts Jurisdiction

1. **LIMITED WARRANTY PERIOD** : For a period of six months from the date of Sale / delivery of the product which ever is earlier. 2. **LIMITED WARRANTY OBLIGATION** : Replacement of defective part(s) by authorized dealer are free of charges. If found defective by reasons of defective material / poor workmanship, parts will be replaced and there will be no value re-imbursement. 3. **TERMS & CONDITIONS** : a. Claims under warranty will be accepted on submission of Warranty Card duly filled and stamped by authorized dealer together with the original purchase document. : b. Shipping / transportation / Incidental charges incurred in replacing defective parts under warranty shall be borne by the purchaser.

**WARRANTY null & void if**

- (i) Lack of maintenance, (ii) Incorrect use of the machine or tampering, (iii) Use of non-genuine spare parts, (iv) Usage of acids, solvents, or any flammable materials, (v) Non-usage of filter water / clear water / soft water & using water above 40°C temperature, (vi) While using the pressure washers to draw water which is contaminated with dust & solvents (eg. paint thinners, gasoline, oil, etc.), (vii) Repair done by unauthorized service people, (viii) Those parts subject to wear & tear due to normal operations and plastic parts, rubber items etc, (ix) Loose connections, faulty electrical fixtures & fluctuations in power supply.
4. Should any failure occur during or after the warranty period, customer does not have the right to interrupt payment / price discount.
5. Incidental or consequential damages like inconvenience commercial loss, loss of tie, mental agony etc.
6. Loss of any nature due to operation or non-operation is not covered under warranty.
7. All free service are at Dealer's service point only.
8. Warranty ceases if service is not done periodically.
9. The attached card should be completed and returned to Ratnagiri Impex Pvt. Ltd. for registration immediately after sale / delivery.
10. The warranty is void unless you register the warranty card with Ratnagiri Impex Pvt. Ltd.
11. The decision of Ratnagiri Impex Pvt. Ltd., in settling the warranty is final in all respects.
12. All disputes are subject to Bangalore Courts Jurisdiction



ratnagiri  
impex  
BRIDGING THE FUTURE - NOW

## 1st Free Service Coupon

ISO 9001-2008  
CERTIFIED COMPANY

FREE SERVICE COUPON (30 Days / 20 hrs (Which ever is earlier))

Model <b>AM-400-PRO-4S BRUSH CUTTER</b>	Serial Number
PDI Date	Service No.
Purchase bill no.	Date

Dealer's Office Seal

Operations:

- Check and Test the Fuel Mixture.
- Check and Clean the Air Filter
- Check, Clean and Adjust the Spark plug
- Check and Adjust the Carburetor Tuning
- Check and Sharpen the cutting Tools
- Start and Check the Noise, Vibration, Loosen / Fasteners etc.
- Product familiarization on Usage
- Routine maintenance and Storage

Dealer Signature.....

Customer Signature.....

Conditions: Operations listed have been performed to my entire satisfaction without any labour charges. Only consumables were charged.



agriculture | horticulture | sericulture | plantations | forestry | garden | health care

WARRANTY AND FREE SERVICE COUPON



ratnagiri  
impex  
BRIDGING THE FUTURE - NOW

## 2nd Free Service Coupon

ISO 9001-2008  
CERTIFIED COMPANY

FREE SERVICE COUPON 60 Days/100 hrs (Which ever is earlier)

Model <b>AM-400-PRO-4S BRUSH CUTTER</b>	Serial Number
PDI Date	Service No.
Purchase bill no.	Date

Dealer's Office Seal

Operations:

- Check and Test the Fuel Mixture.
- Check and Clean the Air Filter
- Check, Clean and Adjust the Spark plug
- Check and Adjust the Carburetor Tuning
- Check and Sharpen the cutting Tools
- Start and Check the Noise, Vibration, Loosen / Fasteners etc.
- Product familiarization on Usage
- Routine maintenance and Storage

Dealer Signature.....

Customer Signature.....

Conditions: Operations listed have been performed to my entire satisfaction without any labour charges. Only consumables were charged.



agriculture | horticulture | sericulture | plantations | forestry | garden | health care

WARRANTY AND FREE SERVICE COUPON



ratnagiri  
impex  
BRIDGING THE FUTURE - NOW

## 3rd Free Service Coupon

ISO 9001-2008  
CERTIFIED COMPANY

FREE SERVICE COUPON 90 Days/200 hrs (Which ever is earlier)

Model <b>AM-400-PRO-4S BRUSH CUTTER</b>	Serial Number
PDI Date	Service No.
Purchase bill no.	Date

Dealer's Office Seal

Operations:

- Check and Test the Fuel Mixture.
- Check and Clean the Air Filter
- Check, Clean and Adjust the Spark plug
- Check and Adjust the Carburetor Tuning
- Check and Sharpen the cutting Tools
- Start and Check the Noise, Vibration, Loosen / Fasteners etc.
- Product familiarization on Usage
- Routine maintenance and Storage

Dealer Signature.....

Customer Signature.....

Conditions: Operations listed have been performed to my entire satisfaction without any labour charges. Only consumables were charged.



agriculture | horticulture | sericulture | plantations | forestry | garden | health care

WARRANTY AND FREE SERVICE COUPON



Small Maintenance. Big Savings.



Small Maintenance. Big Savings.



Small Maintenance. Big Savings.

# Do's & Don'ts

- Always read the instruction manual supplied along with the equipments and understand the correct installation and operating procedures before attempting to use the equipments.
- It is important to use the personal protection equipments such as head helmet with visor, ear defenders, goggles, safety gloves, cut resistant shoes, trousers and jackets while operating potentially dangerous machines.
- Avoid untrained persons using the equipments. Children must not be allowed to handle these equipments.
- Always use genuine spares and accessories in repairs and usage to derive maximum life of the equipments.
- Always keep the equipments in good working condition to minimize loss of output as well as to reduce the pollution and save the environment.
- Do not use the machine within range of persons unless they wear protective clothing.
- Do not operate the machine when fatigued or under the influence of alcohol or drugs.
- When the machine is running, please maintain a constant water supply. Without water circulation will damage the sealing rings of the machine.
- For more query kindly contact for our Service Center/Dealer/ franchise

# Agrimate Army For Pest Control

ANY WHERE - ANY TIME - ANY CROP

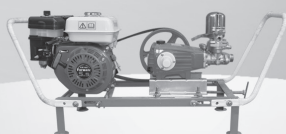

  
**AGRIMATE®**  
Maximum Power - Super Economy

## RATNAGIRI IMPEX PVT. LTD.

Annapurna House, #1/1G, 7th Cross, New Guddadahalli

Mysore Road, Bangalore - 560 026

Customer Care: 1800-425-3036

Email: [marketing@ratnagiriimpex.com](mailto:marketing@ratnagiriimpex.com)



Marketed by:  
 **ratnagiri  
impex**  
BRINGING YOU THE FUTURE... NOW

[www.ratnagiriimpex.com](http://www.ratnagiriimpex.com)

AN ISO 9001:2008 CERTIFIED COMPANY