

INTERCULTIVATOR/POWER WEEDER

AM-RTD-5D-CHAMPION NEW

MANUAL START

TRANSMISSION PART DIAGRAM



INTRODUCTION

Please pursue the contents in the instructions manual prior to using this machine, correctly carried out installation and debugging, as well as use it strictly

according to the working specifications in the instruction manual. The user should be familiar with the safety notices, machine performance and maintenance, etc. The instruction manual will be used in the later use, repair, accessories replacement, and accessories procurement, so please keep it carefully.

OPERATING INSTRUCTION

1. Securely mount the machine on the frame, ensure the two belt pulleys be parallel and on the same plane, and the tension of belt be moderate.
2. Add 30~ 40# machine oil up to 1/2 of oil gauge plug
3. The connectors of each rubber pipe and high pressure pipe must be locked tightly.
4. Before start the motor, open the jet gun and ball cock and loosen the adjusting screw
5. Start the motor, keeping it at appropriate velocity, waiting there is water ejecting from the jet gun, close the jet gun or ball cock, and adjust screw to let the pressure reach the working pressure.
6. Turn on the ball cock and jet gun, beginning spraying. During the process may properly adjust the adjusting screw to maintain the required pressure and lock tightly the fly nut at any moment.
7. After spraying, operate the sprayer with clean water for 2~3 minutes to clean the residual interior chemicals.
8. Firstly dismantle the suction hose, waiting there is no water flowing out from the jet gun or the overflow hose, stop the machine and dismantle overflow hose, high pressure pipe and loosen the adjusting screw.

TECHNICAL SPECIFICATIONS

Model	AM-RTD-5D CHAMPION NEW
Engine	AM-173FD
Starting	MANUAL
Displacement	247CC
Fuel Tank Capacity	2.5LTR
Driving Model	GEAR TRANSMISSION
Oil Capacity in Gear box	1.8LTR
Gears	2 FORWARD,1 REVERSE
Tilling Width	600-1000MM
Tilling Depth	≥150MM
Net Weight	110

Machine's Parts Assembly - A

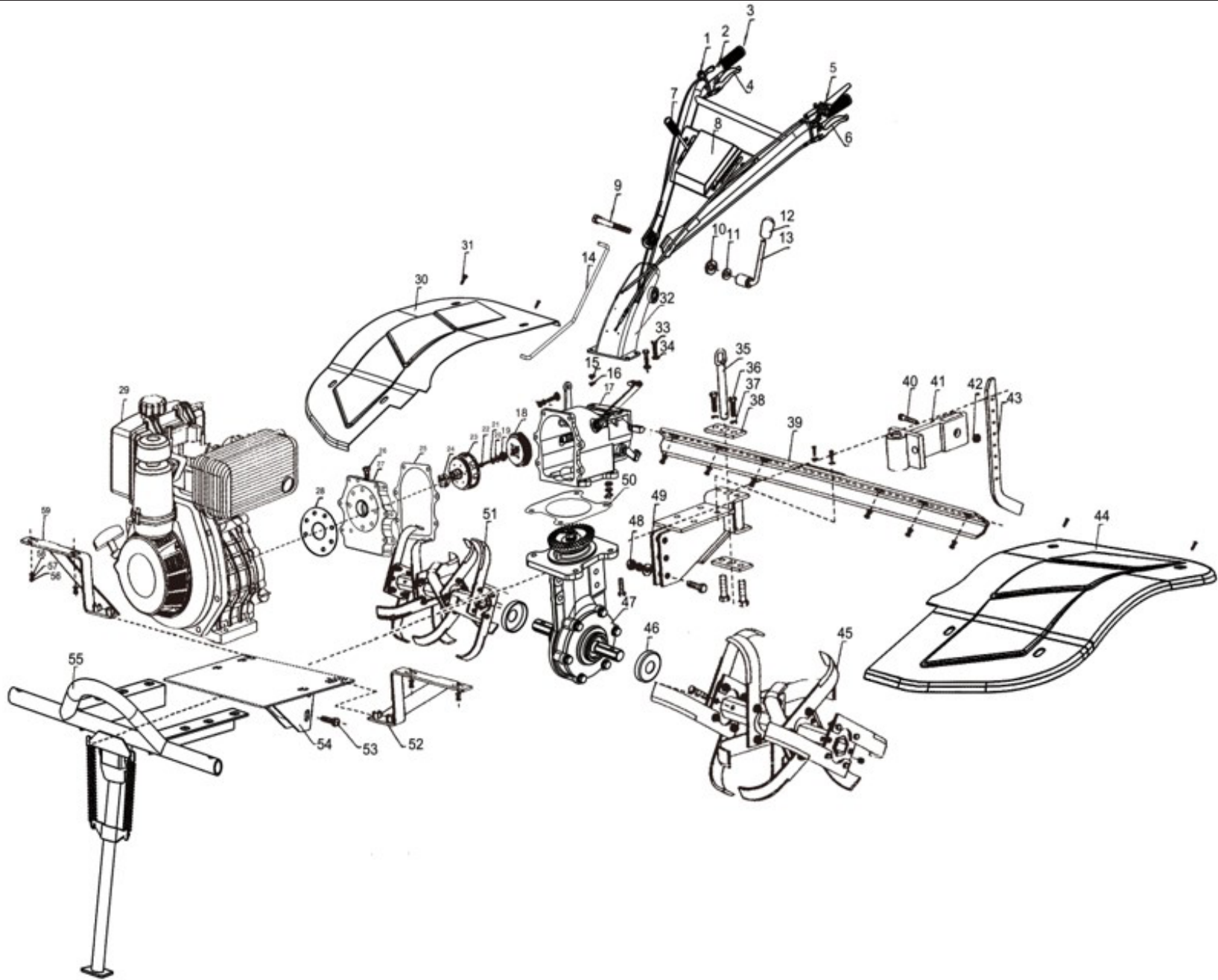

SL NO	PART NO	DESCRIPTION	SL NO	PART NO	DESCRIPTION
1	AM-RTD-5DM-TA01	Throttle	17	AM-RTD-5DM-TA17	Gear Box Assembly
2	AM-RTD-5DM-TA02	Handle	18	AM-RTD-5DM-TA18	Clutch Core
3	AM-RTD-5DM-TA03	Plastic Sleeve	19	AM-RTD-5DM-TA19	Plain Washer
4	AM-RTD-5DM-TA04	Reverse Lever	20	AM-RTD-5DM-TA20	Deep Groove Bearing
5	AM-RTD-5DM-TA05	Immergency Stop Lever	21	AM-RTD-5DM-TA21	Plain Washer
6	AM-RTD-5DM-TA06	Clutch Lever	22	AM-RTD-5DM-TA22	Hexagon Bolt
7	AM-RTD-5DM-TA07	Shift Gear Lever	23	AM-RTD-5DM-TA23	Outer Cover
8	AM-RTD-5DM-TA08	Tool Box	24	AM-RTD-5DM-TA24	Deep Groove Bearing
9	AM-RTD-5DM-TA09	Bolt	25	AM-RTD-5DM-TA25	Flange Gasket
10	AM-RTD-5DM-TA10	Plain Washer	26	AM-RTD-5DM-TA26	Oil Drain Plug
11	AM-RTD-5DM-TA11	Spring Washer	27	AM-RTD-5DM-TA27	Flange
12	AM-RTD-5DM-TA12	Plastic Sleeve	28	AM-RTD-5DM-TA28	Gasket
13	AM-RTD-5DM-TA13	Fix Bar	29	AM-RTD-5DM-TA29	Engine
14	AM-RTD-5DM-TA14	Shift Gear Bar	30	AM-RTD-5DM-TA30	Muddy Fender(Right)
15	AM-RTD-5DM-TA15	Spring Washer	31	AM-RTD-5DM-TA31	Bolt
16	AM-RTD-5DM-TA16	Nut	32	AM-RTD-5DM-TA32	Handle Seat

SL NO	PART NO	DESCRIPTION	SL NO	PART NO	DESCRIPTION
33	AM-RTD-5DM-TA33	Bolt	49	AM-RTD-5DM-TA49	Trailer Body
34	AM-RTD-5DM-TA34	Plain Washer	50	AM-RTD-5DM-TA50	Gasket
35	AM-RTD-5DM-TA35	Big "R" Pin	51	AM-RTD-5DM-TA51	Blades (Right)
36	AM-RTD-5DM-TA36	Bolt	52	AM-RTD-5DM-TA52	Support Bar (Front)
37	AM-RTD-5DM-TA37	Spring Washer	53	AM-RTD-5DM-TA53	Bolt
38	AM-RTD-5DM-TA38	Strengthen Metal Plate	54	AM-RTD-5DM-TA54	Engine Support Plate
39	AM-RTD-5DM-TA39	Support Bar (Back)	55	AM-RTD-5DM-TA55	Bumper
40	AM-RTD-5DM-TA40	Pin Shaft	56	AM-RTD-5DM-TA56	Nut
41	AM-RTD-5DM-TA41	Resistance Bar Connector	57	AM-RTD-5DM-TA57	Spring Washer
42	AM-RTD-5DM-TA42	R Pin	58	AM-RTD-5DM-TA58	Plain Washer
43	AM-RTD-5DM-TA43	Resistance Bar	59	AM-RTD-5DM-TA59	Support Bar (Front)
44	AM-RTD-5DM-TA44	Muddy Fender(Left)	60	AM-RTD-5DM-TA60	
45	AM-RTD-5DM-TA45	Blades (Left)	61	AM-RTD-5DM-TA61	
46	AM-RTD-5DM-TA46	Dustproof Cover	62	AM-RTD-5DM-TA62	
47	AM-RTD-5DM-TA47	Transmission Box Assembly	63	AM-RTD-5DM-TA63	
48	AM-RTD-5DM-TA48	Bolt	64		

HANDLE PARTS ASSY - B

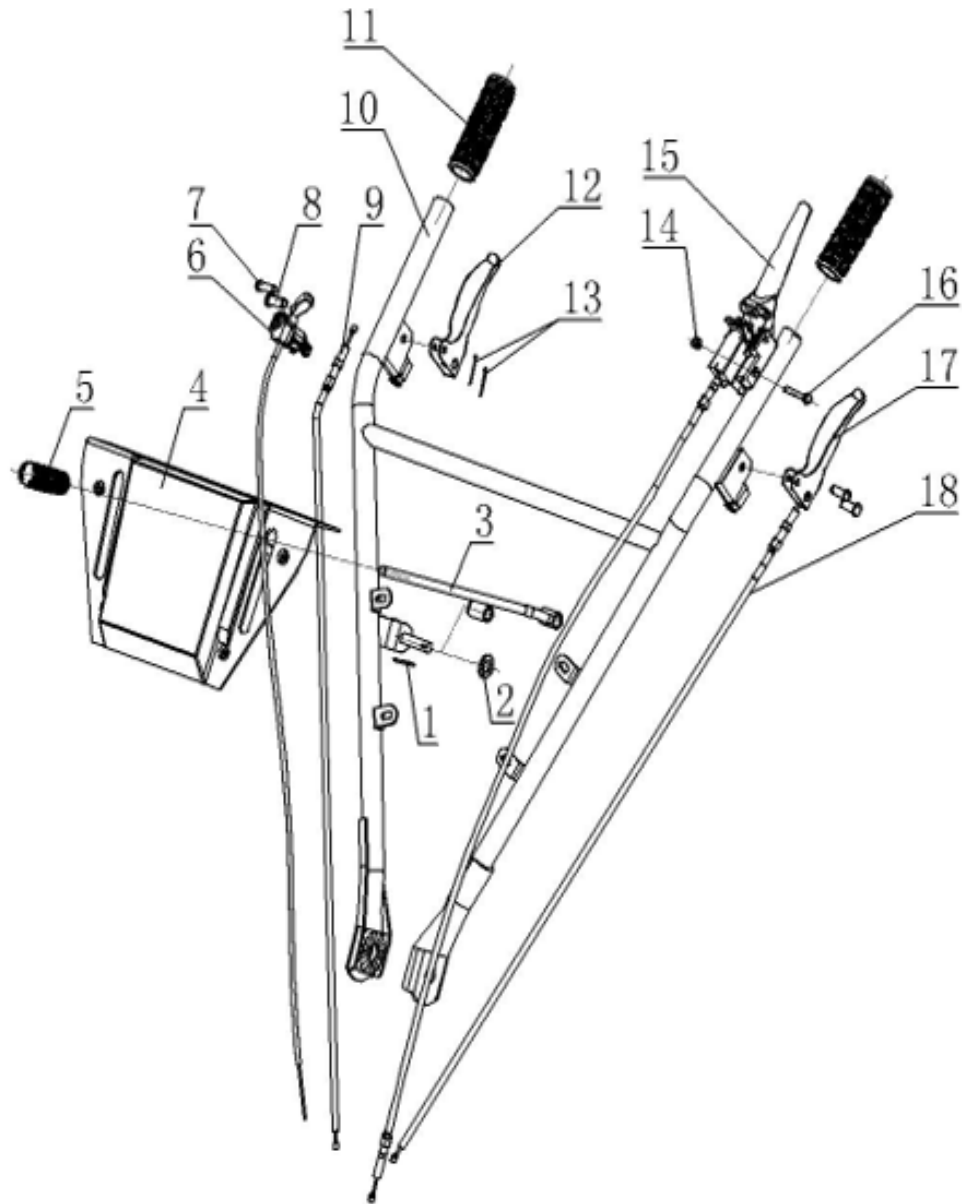

SL NO	PART NO	DESCRIPTION	SL NO	PART NO	DESCRIPTION
1	AM-RTD-5DM-TB01	Split Pin	17	AM-RTD-5DM-TB17	Reverse Lever
2	AM-RTD-5DM-TB02	Plain Washer	18	AM-RTD-5DM-TB18	Reverse Cable
3	AM-RTD-5DM-TB03	Shift Gear Lever			
4	AM-RTD-5DM-TB04	Tool Box			
5	AM-RTD-5DM-TB05	Plastic Sleeve			
6	AM-RTD-5DM-TB06	Throttle			
7	AM-RTD-5DM-TB07	Pin Shaft			
8	AM-RTD-5DM-TB08	Pin Shaft			
9	AM-RTD-5DM-TB09	Cable			
10	AM-RTD-5DM-TB10	Handle			
11	AM-RTD-5DM-TB11	Plastic Sleeve			
12	AM-RTD-5DM-TB12	Clutch Lever			
13	AM-RTD-5DM-TB13	Split Pin			
14	AM-RTD-5DM-TB14	Nut			
15	AM-RTD-5DM-TB15	Emergency Stop Lever			
16	AM-RTD-5DM-TB16	Bolt			

Wheel Part Assy -C

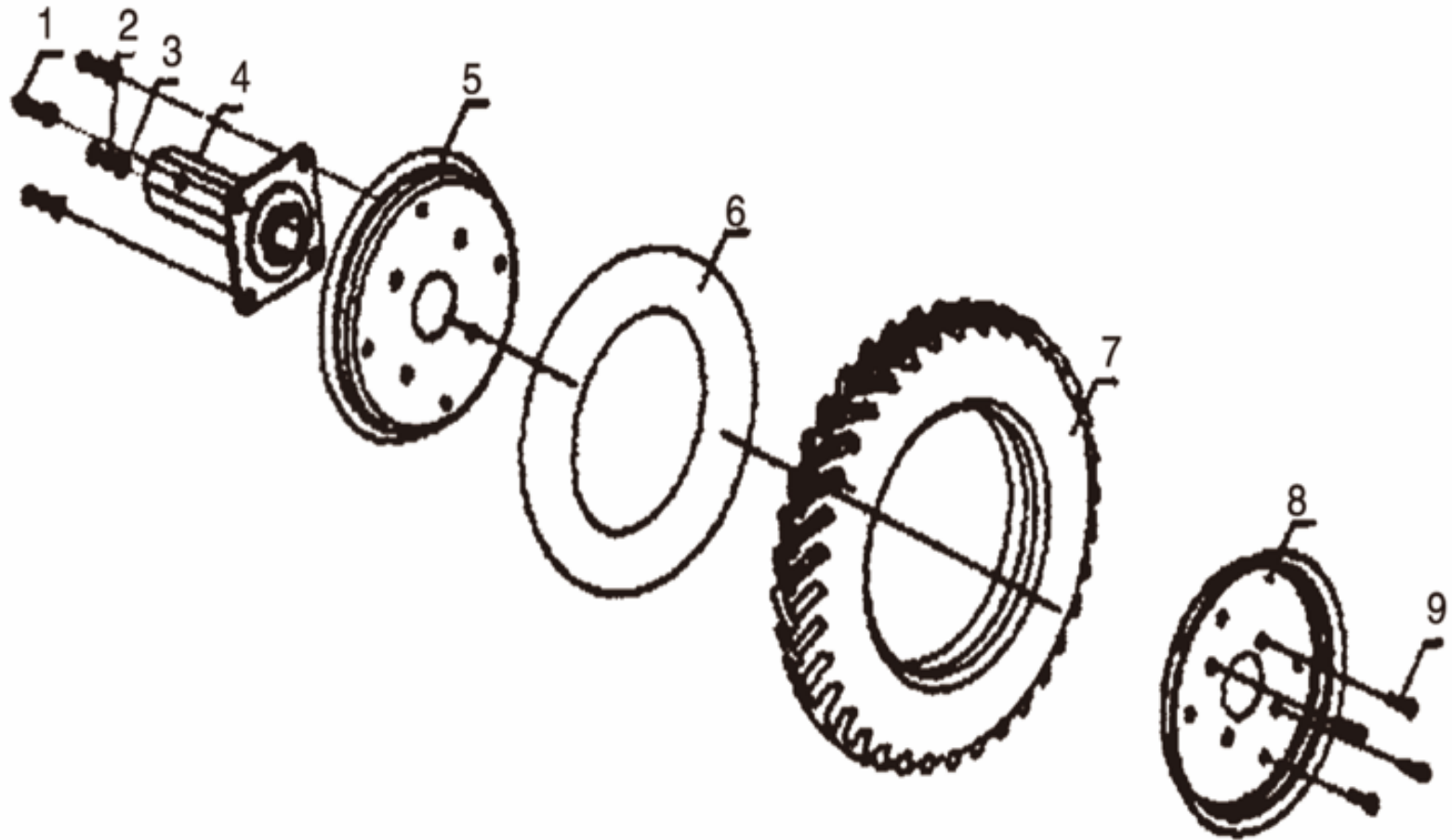

SL NO	PART NO	DESCRIPTION	SL NO	PART NO	DESCRIPTION
1	AM-RTD-5DM-TC01	Bolt			
2	AM-RTD-5DM-TC02	Spring Washer			
3	AM-RTD-5DM-TC03	Nut			
4	AM-RTD-5DM-TC04	Axis			
5	AM-RTD-5DM-TC05	Rim			
6	AM-RTD-5DM-TC06	Tube			
7	AM-RTD-5DM-TC07	Wheel			
8	AM-RTD-5DM-TC08	Rim			
9	AM-RTD-5DM-TC09	Bolt			
10					
11					
12					
13					
14					
15					
16					



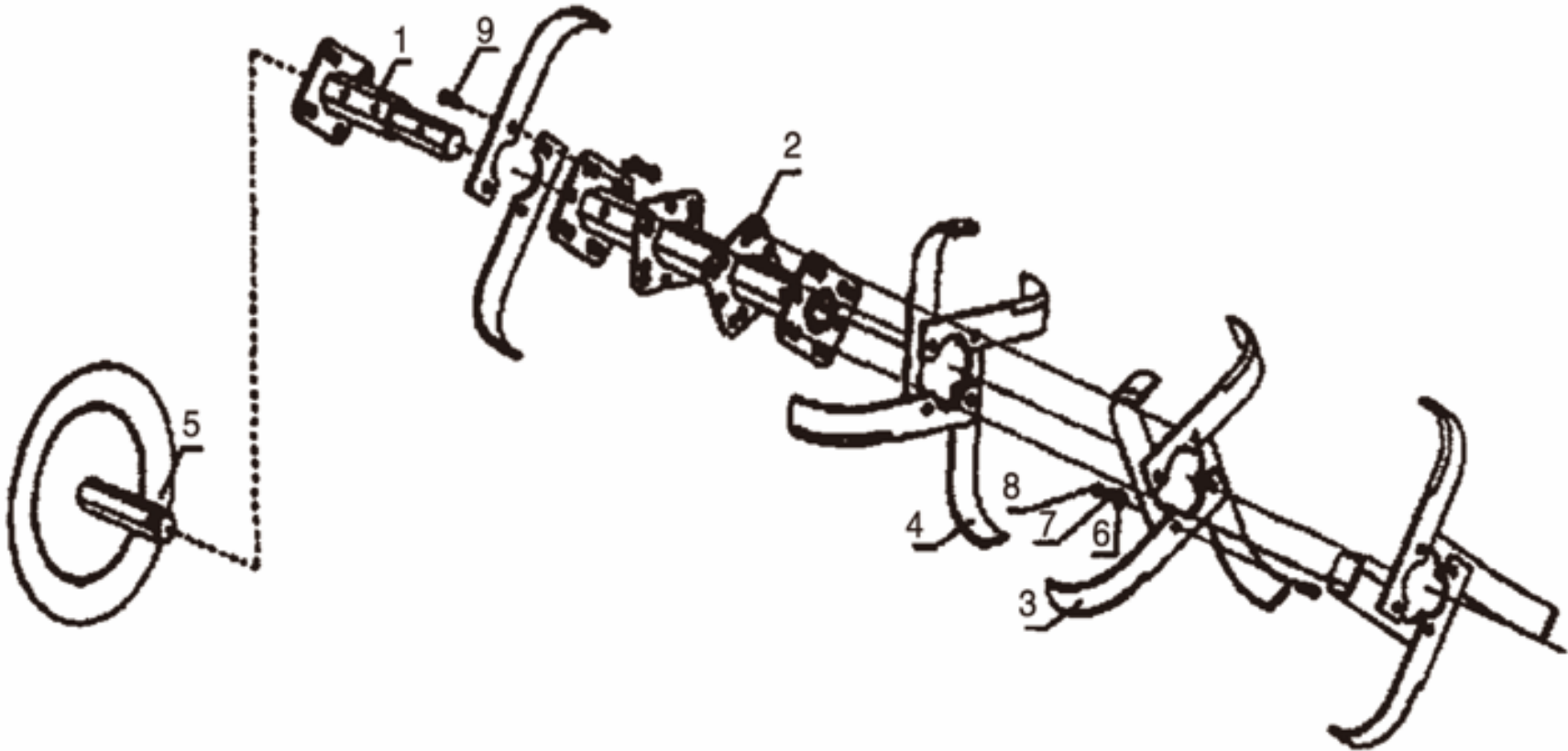

BLADE PARTS ASSY - D



SL NO	PART NO	DESCRIPTION	SL NO	PART NO	DESCRIPTION
1	AM-RTD-5DM-TD01	Sleeve			
2	AM-RTD-5DM-TD02	Blade Shaft			
3	AM-RTD-5DM-TD03	Blade (Left)			
4	AM-RTD-5DM-TD04	Blade (Right)			
5	AM-RTD-5DM-TD05	Round Disc			
6	AM-RTD-5DM-TD06	Bolt			
7	AM-RTD-5DM-TD07	Spring Washer			
8	AM-RTD-5DM-TD08	Plain Washer			
9	AM-RTD-5DM-TD09	Bolt			
10					
11					
12					
13					
14					
15					
16					





WARRANTY CARD

CUSTOMER COPY

DATE _____	DATE OF DELIVERY _____	DEALERS OFFICIAL SEAL	DEALERS SIGN _____
PURCHASERS NAME & ADDRESS _____ _____	 CUSTOMER SIGN		
PRODUCT NAME	PRODUCT SERIAL NO.	INVOICE/DN NO.	
			

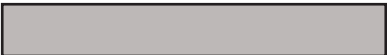



I/Will accept the terms and conditions of warranty as in the warranty card

DEALERS COPY

DATE _____	DATE OF DELIVERY _____	DEALERS OFFICIAL SEAL	DEALERS SIGN _____
PURCHASERS NAME & ADDRESS _____ _____	 CUSTOMER SIGN		
PRODUCT NAME	PRODUCT SERIAL NO.	INVOICE/DN NO.	
			

I/Will accept the terms and conditions of warranty as in the warranty card

COMPANY COPY

DATE _____	DATE OF DELIVERY _____	DEALERS OFFICIAL SEAL	DEALERS SIGN _____
PURCHASERS NAME & ADDRESS _____ _____	 CUSTOMER SIGN		
PRODUCT NAME	PRODUCT SERIAL NO.	INVOICE/DN NO.	
			

I/Will accept the terms and conditions of warranty as in the warranty card

1. LIMITED WARRANTY PERIOD : For a period of six months from the date of Sale / delivery of the product which ever is earlier. 2. LIMITED WARRANTY OBLIGATION : Replacement of defective part(s) by authorized dealer are free of charges. If found defective by reasons of defective material / poor workmanship, parts will be replaced and there will be no value re-imbusement. 3. TERMS & CONDITIONS : a. Claims under warranty will be accepted on submission of Warranty Card duly filled and stamped by authorized dealer together with the original purchase document. : b. Shipping / transportation / Incidental charges incurred in replacing defective parts under warranty shall be borne by the purchaser

WARRANTY null & void if

- (i) Lack of maintenance, (ii) Incorrect use of the machine or tampering, (iii) Use of non-genuine spare parts, (iv) Usage of acids, solvents, or any flammable materials, (v) Non-usage of filter water / clear water / soft water & using water above 40°C temperature, (vi) While using the pressure washers to draw water which is contaminated with dust & solvents (eg. paint thinners, gasoline, oil, etc.), (vii) Repair done by unauthorized service people, (viii) Those parts subject to wear & tear due to normal operations and plastic parts, rubber items etc, (ix) Loose connections, faulty electrical fixtures & fluctuations in power supply.
- 4. Should any failure occur during or after the warranty period, customer does not have the right to interrupt payment / price discount.
- 5. Incidental or consequential damages like inconvenience commercial loss, loss of tie, mental agony etc.
- 6. Loss of any nature due to operation or non-operation is not covered under warranty.
- 7. All free service are at Dealer's service point only.
- 8. Warranty ceases if service is not done periodically.
- 9. The attached card should be completed and returned to Ratnagiri Impex Pvt. Ltd. for registration immediately after sale / delivery.
- 10. The warranty is void unless you register the warranty card with Ratnagiri Impex Pvt. Ltd.
- 11. The decision of Ratnagiri Impex Pvt. Ltd., in settling the warranty is final in all respects.
- 12. All disputes are subject to Bangalore Courts Jurisdiction

1. LIMITED WARRANTY PERIOD : For a period of six months from the date of Sale / delivery of the product which ever is earlier. 2. LIMITED WARRANTY OBLIGATION : Replacement of defective part(s) by authorized dealer are free of charges. If found defective by reasons of defective material / poor workmanship, parts will be replaced and there will be no value re-imbusement. 3. TERMS & CONDITIONS : a. Claims under warranty will be accepted on submission of Warranty Card duly filled and stamped by authorized dealer together with the original purchase document. : b. Shipping / transportation / Incidental charges incurred in replacing defective parts under warranty shall be borne by the purchaser.

WARRANTY null & void if

- (i) Lack of maintenance, (ii) Incorrect use of the machine or tampering, (iii) Use of non-genuine spare parts, (iv) Usage of acids, solvents, or any flammable materials, (v) Non-usage of filter water / clear water / soft water & using water above 40°C temperature, (vi) While using the pressure washers to draw water which is contaminated with dust & solvents (eg. paint thinners, gasoline, oil, etc.), (vii) Repair done by unauthorized service people, (viii) Those parts subject to wear & tear due to normal operations and plastic parts, rubber items etc, (ix) Loose connections, faulty electrical fixtures & fluctuations in power supply.
- 4. Should any failure occur during or after the warranty period, customer does not have the right to interrupt payment / price discount.
- 5. Incidental or consequential damages like inconvenience commercial loss, loss of tie, mental agony etc.
- 6. Loss of any nature due to operation or non-operation is not covered under warranty.
- 7. All free service are at Dealer's service point only.
- 8. Warranty ceases if service is not done periodically.
- 9. The attached card should be completed and returned to Ratnagiri Impex Pvt. Ltd. for registration immediately after sale / delivery.
- 10. The warranty is void unless you register the warranty card with Ratnagiri Impex Pvt. Ltd.
- 11. The decision of Ratnagiri Impex Pvt. Ltd., in settling the warranty is final in all respects.
- 12. All disputes are subject to Bangalore Courts Jurisdiction

1. LIMITED WARRANTY PERIOD : For a period of six months from the date of Sale / delivery of the product which ever is earlier. 2. LIMITED WARRANTY OBLIGATION : Replacement of defective part(s) by authorized dealer are free of charges. If found defective by reasons of defective material / poor workmanship, parts will be replaced and there will be no value re-imbusement. 3. TERMS & CONDITIONS : a. Claims under warranty will be accepted on submission of Warranty Card duly filled and stamped by authorized dealer together with the original purchase document. : b. Shipping / transportation / Incidental charges incurred in replacing defective parts under warranty shall be borne by the purchaser.

WARRANTY null & void if

- (i) Lack of maintenance, (ii) Incorrect use of the machine or tampering, (iii) Use of non-genuine spare parts, (iv) Usage of acids, solvents, or any flammable materials, (v) Non-usage of filter water / clear water / soft water & using water above 40°C temperature, (vi) While using the pressure washers to draw water which is contaminated with dust & solvents (eg. paint thinners, gasoline, oil, etc.), (vii) Repair done by unauthorized service people, (viii) Those parts subject to wear & tear due to normal operations and plastic parts, rubber items etc, (ix) Loose connections, faulty electrical fixtures & fluctuations in power supply.
- 4. Should any failure occur during or after the warranty period, customer does not have the right to interrupt payment / price discount.
- 5. Incidental or consequential damages like inconvenience commercial loss, loss of tie, mental agony etc.
- 6. Loss of any nature due to operation or non-operation is not covered under warranty.
- 7. All free service are at Dealer's service point only.
- 8. Warranty ceases if service is not done periodically.
- 9. The attached card should be completed and returned to Ratnagiri Impex Pvt. Ltd. for registration immediately after sale / delivery.
- 10. The warranty is void unless you register the warranty card with Ratnagiri Impex Pvt. Ltd.
- 11. The decision of Ratnagiri Impex Pvt. Ltd., in settling the warranty is final in all respects.
- 12. All disputes are subject to Bangalore Courts Jurisdiction



FREE SERVICE COUPON (30DAYS/30HRS. WHICHEVER IS EARLIER)

MODEL

SERIAL NUMBER

PDI DATE

SERVICE NO.

PURCHASE BILL NO.

DATE

DEALERS OFFICE SEAL

- 1. Check and test the fuel mixture
- 3. Check , clean and adjust the spark plug
- 5. Check and sparken the cutting tools
- 7. Start and check the noise, vibration, loosen etc..

OPERATIONS

- 2. check and clean the air filter
- 4. Check and adjust the carburetor tuning
- 6. Product familirisation on usage
- 8. Routine maintenance and shortage.

FREE SERVICE COUPON (30DAYS/30HRS. WHICHEVER IS EARLIER)

MODEL

SERIAL NUMBER

PDI DATE

SERVICE NO.

PURCHASE BILL NO.

DATE

DEALERS OFFICE SEAL

- 1. Check and test the fuel mixture
- 3. Check , clean and adjust the spark plug
- 5. Check and sparken the cutting tools
- 7. Start and check the noise, vibration, loosen etc..

OPERATIONS

- 2. check and clean the air filter
- 4. Check and adjust the carburetor tuning
- 6. Product familirisation on usage
- 8. Routine maintenance and shortage.

FREE SERVICE COUPON (30DAYS/30HRS. WHICHEVER IS EARLIER)

MODEL

SERIAL NUMBER

PDI DATE

SERVICE NO.

PURCHASE BILL NO.

DATE

DEALERS OFFICE SEAL

- 1. Check and test the fuel mixture
- 3. Check , clean and adjust the spark plug
- 5. Check and sparken the cutting tools
- 7. Start and check the noise, vibration, loosen etc..

OPERATIONS

- 2. check and clean the air filter
- 4. Check and adjust the carburetor tuning
- 6. Product familirisation on usage
- 8. Routine maintenance and shortage.

DOS

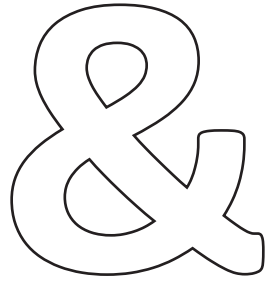

DONT'S

1. Always read the instruction manual supplied along with the equipments and understand the correct installation and operating procedures before attempting to use the equipments.
2. It is important to use the personal protection equipments such as head helmet with visor, ear defenders, goggles, safety gloves, cut resistant shoes, trousers and jackets while operating potentially dangerous machines
3. Avoid untrained persons using the equipments. Children must not be allowed to handle these equipments
4. Always use genuine spares and accessories in repairs and usage to derive maximum life of the equipments.
5. Always keep the equipments in good working condition to minimize loss of output as well as to reduce the pollution and save the environment
6. Do not use the machine within range of persons unless they wear protective clothing
7. Do not operate the machine when fatigued or under the influence of alcohol or drugs
8. When the machine is running, please maintain a constant water supply. Without water circulation will damage the sealing rings of the machine.
9. For more query kindly contact for our Service Center/Dealer/ franchise

Agrimate Army For Pest Control

ANY WHERE - ANY TIME - ANY CROP

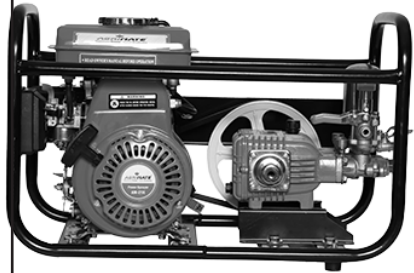
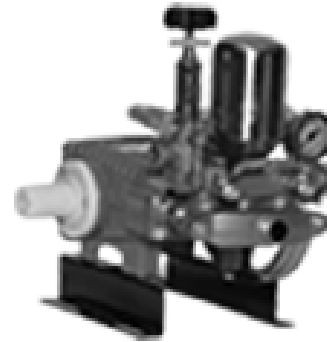

Marketed by:
**ratnagiri
impex**
BRINGING YOU THE FUTURE... NOW

RATNAGIRI IMPEX PVT., LTD.,

Annapurna House, #1 / 1G, 7th Cross, New
Guddadahalli

Mysore Road, Bangalore - 560 026

Missed Call : 7393 938 938

Email: ask@agrimart.in