

AM-405E BATTERY SPRAYER



BEFORE OPERATING THIS MACHINE,
PLEASE READ THESE INSTRUCTIONS CAREFULLY



**ratnagiri
impex**

BRINGING YOU THE FUTURE... NOW



Dear Sir/Madam,

Thank you for choosing Agrimate product. You are the proud owner of high technology and durable machine. Trust that our franchisee/dealer installed the product and explained you about the usage and service instructions. Please visit our authorised dealer for your future requirement of our other equipments, genuine spares, accessories and service. Service coupons are attached with this manual and you can avail free service.

About Ratnagiri

We import and market of high quality of agriculture wide range of equipment's Which we are selling through our authorized franchisee or dealer network. We are in this field from past 20 years serving the former community. For further details, you may please visit our website www.agrimart.in.

Range of Brands



Our Retail Formats



Agriculture | Horticulture | Sericulture | Plantations | Forestry | Garden | Health care

Salient Features:

- Tank body inspired from the shape of Human Backbone & ribcage.
- Very Strong & Durable Sprayer.

SPECIFICATIONS

CAPACITY	: 16/18L
TANK MATERIAL	: PP
WORKING PRESSURE	: Upto 0.55MPA
BATTERY	: 12V/12AH
LANCE	: SS lance, Steel Pistone with three brass end and bend with regulator
Auto Pump	: 3.6L <ul style="list-style-type: none">• Single nozzle + 4 holes Nozzle + Double Nozzle + 8 holes nozzle in Indian Thread• 5W LED with 5M cable and switch.• Shoulder belt with thick cushion• Steel pressure pump

NOTE

Please fix the filter before putting the spray chemical.

STORE

Every time after using, Please clean the pump, then charge 10-12 hours, keep it in dry and shady place.

WARNING

This battery is with self discharged type, please recharge it once in a month. When it is not in use regularly. Otherwise battery will be discharged fully and will not be recharged again.

MAINTENANCE

1. Each time after using, the sprayer must be recharged to maintain inside power and to avoid short working life.
2. When doing charge or discharge, please ensure that you have switched off the sprayer to avoid wasting power.
3. After using the sprayer, it should be recharged, If not using the sprayer for a long time, please charge the battery approx once in a month to retain life-span of battery.
4. After using the sprayer, please keep outside and inside of the sprayer clean.
5. Keep the sprayer in the shady place, don't store the sprayer under direct sunlight.
6. Please keep no residue of insecticide, fertilizer or herbicide at bottom of the tank, keep bottom dry so as to avoid corrosion.

SAFETY WARNING

If you are using the sprayer with hazardous or poisonous liquid, use only with directions supplied by the manufacturer of the hazardous or poisonous liquid. Please clean the sprayer thoroughly after use.

PART DIAGRAM & PART LIST OF AM-405E-BATTERY SPRAYER

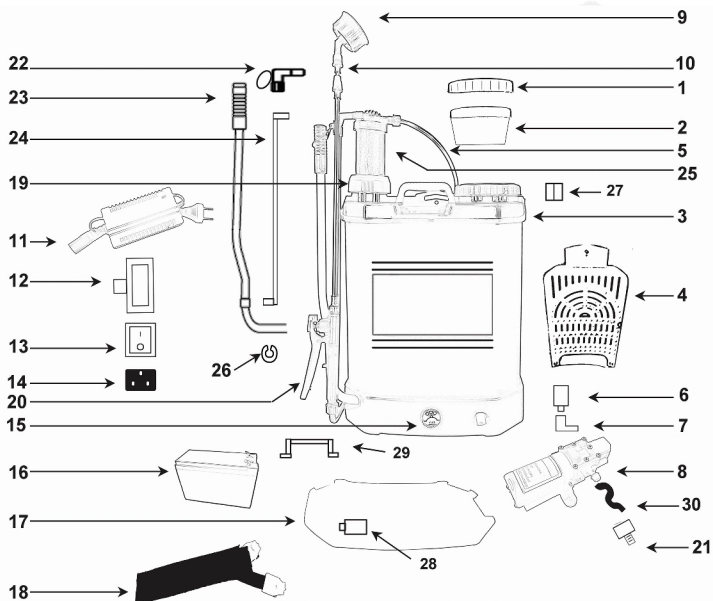

PART NO	DESCRIPTION
AM - 405E - 01	Tank cap
AM - 405E - 02	Strainer
AM - 405E - 03	Tank
AM - 405E - 04	Backrest
AM - 405E - 05	Hose
AM - 405E - 06	Inner filter
AM - 405E - 07	Elbow
AM - 405E - 08	Auto pump
AM - 405E - 09	Indian 8 holes nozzle
AM - 405E - 9.2	Indian single nozzle
AM - 405E - 9.3	Indian 4 holes nozzle
AM - 405E - 9.4	Indian double nozzle
AM - 405E - 10	Indian lance brass end
AM - 405E - 11	1.7A Charger
AM - 405E - 12	Regulator
AM - 405E - 13	On/off switch
AM - 405E - 14	Charging socket

PART NO	DESCRIPTION
AM - 405E - 15	Volt meter
AM - 405E - 16	12V/8AH battery
AM - 405E - 17	Bottom plate
AM - 405E - 18	Car belt
AM - 405E - 19	Pump ring cap
AM - 405E - 20	Trigger
AM - 405E - 21	Pump outlet connector
AM - 405E - 22	Link rod clip and Handle ring
AM - 405E - 23	Handle
AM - 405E - 24	Link rod
AM - 405E - 25	Pressure pump
AM - 405E - 26	Handle C rock
AM - 405E - 27	Lance clip
AM - 405E - 28	Bottom window cover
AM - 405E - 29	Battery clip
AM - 405E - 30	Inner hose

PARTS LIST OF AM-405E- BATTERY SPRAYER



AM 405E-01
Tank cap



AM 405E-02
Strainer



AM 405E-03
Tank



AM 405E-04
Backrest



AM 405E-05
Hose



AM 405E-06
Inner filter



AM 405E-07
Elbow



AM 405E-08
Auto Pump



AM 405E-09
Indian 8 holes nozzle



AM 405E-9.2
Indian single nozzle



AM 405E-9.3
Indian 4 holes nozzle



AM 405E-9.4
Indian double nozzle



AM 405E-10
Indian lance brass end



AM 405E-11
1.7A Charger



AM 405E-12
Regulator

PARTS LIST OF AM-405E-BATTERY SPRAYER



AM 405E-13
On/off switch



AM 405E-14
Charging socket



AM 405E-15
Volt meter



AM 405E-16
12V/8AH battery



AM 405E-17
Bottom plate



AM 405E-18
Car belt



AM 405E-19
Pump ring cap



AM 405E-20
Trigger



AM 405E-21
Pump outlet connector



AM 405E-22
Link rod clip and Handle ring



AM 405E-23
Handle



AM 405E-24
Link rod



AM 405E-25
Pressure pump



AM 405E-26
Handle C rock



AM 405E-27
Lance clip



AM 405E-28
Bottom window cover



AM 405E-29
Battery clip



AM 405E-30
Inner hose

Warranty Card

CUSTOMER COPY



Purchaser's Name & Address

Product Name

AM-405E-BATTERY SPRAYER

Product Serial No.

Invoice / DN No.

Date of Delivery

Dealer's Office Seal

Dealer Sign _____

Customer Sign. _____

I/We accept the terms and conditions of Warranty as in the Warranty Card.

Warranty Card

DEALER'S COPY



Purchaser's Name & Address

Product Name

AM-405E-BATTERY SPRAYER

Product Serial No.

Invoice / DN No.

Date of Delivery

Dealer's Office Seal

Dealer Sign _____

Customer Sign. _____

I/We accept the terms and conditions of Warranty as in the Warranty Card.

Warranty Card

COMPANY COPY



Purchaser's Name & Address

Product Name

AM-405E-BATTERY SPRAYER

Product Serial No.

Invoice / DN No.

Date of Delivery

Dealer's Office Seal

Dealer Sign _____

Customer Sign. _____

I/We accept the terms and conditions of Warranty as in the Warranty Card.

1. **LIMITED WARRANTY PERIOD** : For a period of six months from the date of Sale / delivery of the product which ever is earlier. 2. **LIMITED WARRANTY OBLIGATION** : Replacement of defective part(s) by authorized dealer are free of charges. If found defective by reasons of defective material / poor workmanship, parts will be replaced and there will be no value re-imbursement. 3. **TERMS & CONDITIONS** : a. Claims under warranty will be accepted on submission of Warranty Card duly filled and stamped by authorized dealer together with the original purchase document. : b. Shipping / transportation / Incidental charges incurred in replacing defective parts under warranty shall be borne by the purchaser.

WARRANTY null & void if

- (i) Lack of maintenance, (ii) Incorrect use of the machine or tampering, (iii) Use of non-genuine spare parts, (iv) Usage of acids, solvents, or any flammable materials, (v) Non-usage of filter water / clear water / soft water & using water above 40°C temperature, (vi) While using the pressure washers to draw water which is contaminated with dust & solvents (eg. paint thinners, gasoline, oil, etc.), (vii) Repair done by unauthorized service people, (viii) Those parts subject to wear & tear due to normal operations and plastic parts, rubber items etc, (ix) Loose connections, faulty electrical fixtures & fluctuations in power supply.
- 4. Should any failure occur during or after the warranty period, customer does not have the right to interrupt payment / price discount.
- 5. Incidental or consequential damages like inconvenience commercial loss, loss of tie, mental agony etc.
- 6. Loss of any nature due to operation or non-operation is not covered under warranty.
- 7. All free service are at Dealer's service point only.
- 6. Warranty ceases if service is not done periodically.
- 9. The attached card should be completed and returned to Ratnagiri Impex Pvt. Ltd. for registration immediately after sale / delivery.
- 10. The warranty is void unless you register the warranty card with Ratnagiri Impex Pvt. Ltd.
- 11. The decision of Ratnagiri Impex Pvt. Ltd., in settling the warranty is final in all respects.
- 12. All disputes are subject to Bangalore Courts Jurisdiction

1. **LIMITED WARRANTY PERIOD** : For a period of six months from the date of Sale / delivery of the product which ever is earlier. 2. **LIMITED WARRANTY OBLIGATION** : Replacement of defective part(s) by authorized dealer are free of charges. If found defective by reasons of defective material / poor workmanship, parts will be replaced and there will be no value re-imbursement. 3. **TERMS & CONDITIONS** : a. Claims under warranty will be accepted on submission of Warranty Card duly filled and stamped by authorized dealer together with the original purchase document. : b. Shipping / transportation / Incidental charges incurred in replacing defective parts under warranty shall be borne by the purchaser.

WARRANTY null & void if

- (i) Lack of maintenance, (ii) Incorrect use of the machine or tampering, (iii) Use of non-genuine spare parts, (iv) Usage of acids, solvents, or any flammable materials, (v) Non-usage of filter water / clear water / soft water & using water above 40°C temperature, (vi) While using the pressure washers to draw water which is contaminated with dust & solvents (eg. paint thinners, gasoline, oil, etc.), (vii) Repair done by unauthorized service people, (viii) Those parts subject to wear & tear due to normal operations and plastic parts, rubber items etc, (ix) Loose connections, faulty electrical fixtures & fluctuations in power supply.
- 4. Should any failure occur during or after the warranty period, customer does not have the right to interrupt payment / price discount.
- 5. Incidental or consequential damages like inconvenience commercial loss, loss of tie, mental agony etc.
- 6. Loss of any nature due to operation or non-operation is not covered under warranty.
- 7. All free service are at Dealer's service point only.
- 8. Warranty ceases if service is not done periodically.
- 9. The attached card should be completed and returned to Ratnagiri Impex Pvt. Ltd. for registration immediately after sale / delivery.
- 10. The warranty is void unless you register the warranty card with Ratnagiri Impex Pvt. Ltd.
- 11. The decision of Ratnagiri Impex Pvt. Ltd., in settling the warranty is final in all respects.
- 12. All disputes are subject to Bangalore Courts Jurisdiction

1. **LIMITED WARRANTY PERIOD** : For a period of six months from the date of Sale / delivery of the product which ever is earlier. 2. **LIMITED WARRANTY OBLIGATION** : Replacement of defective part(s) by authorized dealer are free of charges. If found defective by reasons of defective material / poor workmanship, parts will be replaced and there will be no value re-imbursement. 3. **TERMS & CONDITIONS** : a. Claims under warranty will be accepted on submission of Warranty Card duly filled and stamped by authorized dealer together with the original purchase document. : b. Shipping / transportation / Incidental charges incurred in replacing defective parts under warranty shall be borne by the purchaser.

WARRANTY null & void if

- (i) Lack of maintenance, (ii) Incorrect use of the machine or tampering, (iii) Use of non-genuine spare parts, (iv) Usage of acids, solvents, or any flammable materials, (v) Non-usage of filter water / clear water / soft water & using water above 40°C temperature, (vi) While using the pressure washers to draw water which is contaminated with dust & solvents (eg. paint thinners, gasoline, oil, etc.), (vii) Repair done by unauthorized service people, (viii) Those parts subject to wear & tear due to normal operations and plastic parts, rubber items etc, (ix) Loose connections, faulty electrical fixtures & fluctuations in power supply.
- 4. Should any failure occur during or after the warranty period, customer does not have the right to interrupt payment / price discount.
- 5. Incidental or consequential damages like inconvenience commercial loss, loss of tie, mental agony etc.
- 6. Loss of any nature due to operation or non-operation is not covered under warranty.
- 7. All free service are at Dealer's service point only.
- 8. Warranty ceases if service is not done periodically.
- 9. The attached card should be completed and returned to Ratnagiri Impex Pvt. Ltd. for registration immediately after sale / delivery.
- 10. The warranty is void unless you register the warranty card with Ratnagiri Impex Pvt. Ltd.
- 11. The decision of Ratnagiri Impex Pvt. Ltd., in settling the warranty is final in all respects.
- 12. All disputes are subject to Bangalore Courts Jurisdiction



ratnagiri
impex
BRINDHAN TRADING CORPORATION, NEW

1st Free Service Coupon

ISO 9001-2015
CERTIFIED COMPANY

FREE SERVICE COUPON (30 Days / 30 hrs (Which ever is earlier))

Model

AM-405E-BATTERY SPRAYER

Serial Number

PDI Date

Purchase bill no.

Date

Service No.

Dealer's Office Seal

Operations:

- Check and Test the Fuel Mixture.
- Check and Clean the Air Filter
- Check, Clean and Adjust the Spark plug
- Check and Adjust the Carburetor Tuning
- Check and Sharpen the cutting Tools
- Start and Check the Noise, Vibration, Loosen / Fasteners etc.
- Product familiarization on Usage
- Routine maintenance and Storage

Dealer Signature.....

Customer Signature.....

Conditions: Operations listed have been performed to my entire satisfaction without any labour charges. Only consumables were



agriculture horticulture sericulture plantation forestry garden health care

WARRANTY AND FREE SERVICE COUPON



ratnagiri
impex
BRINDHAN TRADING CORPORATION, NEW

2nd Free Service Coupon

ISO 9001-2015
CERTIFIED COMPANY

FREE SERVICE COUPON (60Days / 60hrs (Which ever is earlier))

Model

AM-405E-BATTERY SPRAYER

Serial Number

PDI Date

Purchase bill no.

Date

Service No.

Dealer's Office Seal

Operations:

- Check and Test the Fuel Mixture.
- Check and Clean the Air Filter
- Check, Clean and Adjust the Spark plug
- Check and Adjust the Carburetor Tuning
- Check and Sharpen the cutting Tools
- Start and Check the Noise, Vibration, Loosen / Fasteners etc.
- Product familiarization on Usage
- Routine maintenance and Storage

Dealer Signature.....

Customer Signature.....

Conditions: Operations listed have been performed to my entire satisfaction without any labour charges. Only consumables were Charged



agriculture horticulture sericulture plantation forestry garden health care

WARRANTY AND FREE SERVICE COUPON



ratnagiri
impex
BRINDHAN TRADING CORPORATION, NEW

3rd Free Service Coupon

ISO 9001-2015
CERTIFIED COMPANY

FREE SERVICE COUPON (90Days / 120hrs (Which ever is earlier))

Model

AM-405E-BATTERY SPRAYER

Serial Number

PDI Date

Purchase bill no.

Date

Service No.

Dealer's Office Seal

Operations:

- Check and Test the Fuel Mixture.
- Check and Clean the Air Filter
- Check, Clean and Adjust the Spark plug
- Check and Adjust the Carburetor Tuning
- Check and Sharpen the cutting Tools
- Start and Check the Noise, Vibration, Loosen / Fasteners etc.
- Product familiarization on Usage
- Routine maintenance and Storage

Dealer Signature.....

Customer Signature.....

Conditions: Operations listed have been performed to my entire satisfaction without any labour charges. Only consumables were Charged



agriculture horticulture sericulture plantation forestry garden health care

WARRANTY AND FREE SERVICE COUPON

Do's & Don'ts

- Always read the instruction manual supplied along with the equipments and understand the correct installation and operating procedures before attempting to use the equipments.
- It is important to use the personal protection equipments such as head helmet with visor, ear defenders, goggles, safety gloves, cut resistant shoes, trousers and jackets while operating potentially dangerous machines.
- Avoid untrained persons using the equipments. Children must not be allowed to handle these equipments.
- Always use genuine spares and accessories in repairs and usage to derive maximum life of the equipments.
- Always keep the equipments in good working condition to minimise loss of output as well as to reduce the pollution and save the environment.
- Do not use the machine within range of persons unless they wear protective clothing.
- Do not operate the machine when fatigued or under the influence of alcohol or drugs.
- To reduce the risk of injury, close supervision is necessary when a machine is used near children. Equipment shall not be used by children or untrained person.
- Disconnect from the battery power supply before carrying out user maintenance.

MULTIPLY PROFITS

WITH OUR MULTI CROP, MULTI PURPOSE EQUIPMENTS



RANGE OF PRODUCTS



BATTERY /
MANUAL
SPRAYER



PORTABLE
POWER
SPRAYER



KNAPSACK
POWER
SPRAYER



ROTARY
TILLER



CHAFF
CUTTER



TEA
PRUNER



FOGGER



POWER
WEEDER



CHAINSAW



ROTARY
TILLER



LAWN
MOWER



HIGH
PRESSURE
WASHER



EARTH
AUGER



RIDE ON
MOWER



RANGE OF PRODUCTS



Advanced Technology

RANGE OF PRODUCTS



BRUSH CUTTER
- PUSH TYPE



BRUSH CUTTER -
BACK PACK



BRUSH CUTTER -
MULTI TOOL



POLE PRUNER



BLOWER
BACK PACK



LAWN MOWER



BRUSH
CUTTER



BACK PACK
BC



TILLER



FOGGER



EARTH
AUGER



Green Panther®

RANGE OF PRODUCTS

OUR RETAIL FORMATS



IMPORTERS & MARKETING BY:

Ratnagiri Impex Pvt. Ltd.

Annapurna House, # 1/1G,

7th Cross New Guddadahalli,

Mysore Road Bangalore - 560 026, India

Ph: 080-26985100/1/2

Email: info@ratnagiriimpex.com



TOLL FREE :
1800-425-3036

www.ratnagiriimpex.com

www.agrimart.in



An ISO 9001:2015 Certified Company

agriculture | horticulture | sericulture | plantations | forestry | garden | health care